

**LAND CORNER RECORDATION CERTIFICATE**  
**Filing Requirement of Act 74, Mich. P.A. 1970**

For corners in  
**MONTCALM**

	Located In:	Corner Code $\neq$
(County)		
1. Public Land Survey	T <u>9N</u> R <u>8W</u>	<u>F-11</u>
	T _____ R _____	_____
	T _____ R _____	_____
	T _____ R _____	_____
2. Property Controlling in Section	S _____ T _____ R _____	_____
	S _____ T _____ R _____	_____
3. Miscellaneous Property in Sec.	S _____ T _____ R _____	_____
	S _____ T _____ R _____	_____

Register of Deeds Stamp & File Number

4. Lot No. \_\_\_\_\_, Recorded Plat \_\_\_\_\_  
 5. Private Claims \_\_\_\_\_

	A	B	C	D	E	F	G	H	I	J	K	L	M
2	6	5	4	3	2	1							
3													
4	7	8	9	10	11	12							
5													
6	18	17	16	15	14	13							
7													
8	19	20	21	22	23	24							
9													
10	30	29	28	27	26	25							
11													
12	31	32	33	34	35	36							
13													

I, GARY C. BILOW, in a field survey on AUGUST 3, 19 90, do hereby certify that under requirements of P.A. 74, Michigan P.A. of 1970, the corner points mentioned in lines 1 and 2 above were in conformance with regulations and rules therefore as required in the current manual of survey instructions of the United States Department of the Interior, Bureau of Land Management or by a decree of a Court of Law and/or that the corner points mentioned in lines 3, 4 and 5 above were in conformance with the rules of the Michigan Board of Land Surveyors or by a Decree of a Court of Law; established, re-established, monumented, re-monumented, recovered, found as expressed below:

**NOTE: Not more than 4 corners, all in the same town and range, may be recorded on this certificate.**

**A. Description of original monument and accessories and/or subsequent restoration:**

CORNER POST ESTABLISHED BY GLO DEPUTY SURVEYOR W. BROOKFIELD, 1837. ACCESSORIES: ELM 10 S71W 11; W. OAK 10 N39E 10. COUNTY SURVEYOR EDWARD H. JONES NOTES NEW BT'S IN MAY, 1892: W. OAK 24, N76W 61.2; SWAMP OAK 4 S50E 35.1(L.2, P.18 CO. SURVEYOR RECORD). CO. SURVEYOR R.D. McNUTT NOTES IN MARCH, 1915: "POINTED STONE AND GLASS. NBT S. OAK 12 S50E 27-1/2; W. OAK 6, S351/4 W 82. 1927 MICH. STATE HWY DEPT. PLANS (PROJ. #034-26 AND #059-18 SEC. A) DO NOT SHOW CORNER MONUMENT FOUND NOR SET. IN 1957, MSHD FOUND PK NAIL AND WITNESSED AS FOLLOWS: STATION 203+90.81, 5.71' RT., S70W 29.81' 32" ELM; S23W 54.95' 18" OAK; N78E 28.79' 25" ELM. MICHIGAN DEPT. OF TRANSPORTATION RECORDS SHOW THAT IN NOV. 1978, H. POTTER OF GLAZA AND ASSOC. SET PK NAIL FROM "OLD WITNESSES AND REWITNESSED" AS FOLLOWS: S80W, 44.2' NAIL N. SIDE 4" PINE; N85W, 47.0' NAIL S. SIDE 8" BOX ELDER; N35E, 66.0' NAIL NW SIDE 18" WILD CHERRY. RECORDS OF GLAZA AND ASSOC. SHOW THAT "OLD WITNESSES" REFERRED TO APPEAR TO BE MDOT'S 1957 STATION AND OFFSET MEASUREMENTS TO THE CORNER. RICHARD J. CRATER HAS RECORDED THIS PK NAIL USING POTTER'S ACCESSORIES (SEE LCRC RECORDED LIBER 1, PAGE 476, MONTCALM COUNTY RECORDS).

**B. Description of corner evidence found and/or method applied in restoring or reestablishing corner:**

FOUND NO EVIDENCE OF ORIGINAL CORNER POST OR ACCESSORIES. 1957 MSHD WITNESSES HAVE BEEN DESTROYED. LOCATED PK NAIL RECORDED BY CRATER BUT DID NOT ACCEPT IT AS REPRESENTING THE CORNER LOCATION. RESTORED CORNER AT POSITION FOUND BY MSHD IN 1957 USING RECORD AND PRORATED 1957 MSHD STATION AND OFFSET MEASUREMENTS. RECOVERED S1/4 CORNER OF SECTION 33 AND N1/4 CORNER OF SECTION 28, BOTH STATIONED ON 1927 HIGHWAY PLANS. RECONSTRUCTED THE CENTERLINE OF HWY M-91 BASED ON THESE CORNERS AND MDOT CENTERLINE DATA FROM PLANS NOTED ABOVE. DETERMINED THAT THERE IS A SHORTAGE OF 1.23' BETWEEN THESE CORNERS COMPARED TO MDOT MEASURE. PRORATED LATITUDINAL POSITION OF CORNER BASED ON THIS DIFFERENCE AND SET A PK NAIL AT THIS PRORATED POSITION 5.71' EAST OF AND AT RIGHT ANGLES TO THE RECONSTRUCTED CENTERLINE. FROM THIS POSITION, PK NAIL PREVIOUSLY RECORDED AS THE CORNER FALLS NORTHERLY, 4.28' DISTANT. CORNER POSITION AS RESTORED IS SUPPORTED BY MONUMENTED 1/8 LINE TO THE SOUTH. THE CALCULATED POSITION OF THE NORTH 1/8 CORNER OF SECTION 33 (CORNER 5) BASED ON THE N1/4 CORNER AS RESTORED AND F-12 (AS RECORDED ON LCRC LIBER 2, PAGE 177 AND RERECORDED THIS DATE) AGREES WELL WITH FOUND MONUMENTATION ALONG THE 1/8 LINE ON THE WEST SIDE OF M-91.

**C. Description of monument for corner and accessories established to perpetuate locating the position of the corner:**  
 SET PK NAIL

- N05E 4.28' FOUND PK NAIL RECORDED AS THE CORNER ON LCRC LIBER 1, PAGE 476
- N80W 35.36' FOUND PIPE
- N80E 30.78' FOUND 1/2" DIA. REBAR
- EAST 44.29' SET 1/2"x3/8" REBAR ENCASED IN A 4" DIA. CONCRETE CYLINDER AND CAPPED WITH A CAST ALUMINUM MICHIGAN DEPT. OF NATURAL RESOURCES TABLET AT THE INTERSECTION OF THE NORTH LINE OF SECTION 33 WITH THE EAST 1/4 R/W LINE OF HWY M-91.
- N75W 47.40' SET SPIKE AND MDNR TAG IN BOX ELDER
- S73W 48.12' SET SPIKE AND MDNR TAG IN WHITE PINE.

Signed by Gary C. BiLOW  
 Surveyor's Michigan License No. 26453

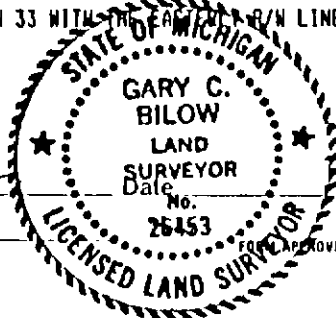

APPROVED BY MICHIGAN STATE BOARD OF LAND SURVEYORS, JAN. 28, 1971  
 REVISED MAY 14, 1975  
 REVISED JAN., 1983