

JAN 17 1996 MONTCALM COUNTY REMONUMENTATION PROGRAM
LAND CORNER RECORDATION CERTIFICATE
COMMISSION Filing Requirement of Act 74, Mich. P.A. 1970

For corners in
Montcalm
(County) Located in: Eureka Township Corner Code # _____

1. Public Land Survey Sec 5 T 9 N R 8 W D-3, S-1/4
T _____ R _____
T _____ R _____
T _____ R _____

2. Property Controlling in Section S _____ T _____ R _____
S _____ T _____ R _____

3. Miscellaneous Property in Sec. S _____ T _____ R _____
S _____ T _____ R _____

4. Lot No. _____, Recorded Plat _____

5. Private Claims _____

STATE OF MICHIGAN
MONTCALM COUNTY
RECORDED
20 DEC 95 11:37 A.M.
VIRGINIA L. KNEPPER
REGISTER OF DEEDS
Register of Deeds Stamp & File Number

I, William Tingley a field survey on February 10, 1995, do hereby certify that under requirements of P.A. 74, Michigan P.A. of 1970, the corner points mentioned in lines 1 and 2 above were in conformance with regulations and rules therefore as required in the current manual of survey instructions of the United States Department of the Interior, Bureau of Land Management or by a decree of a Court of Law and/or that the corner points mentioned in lines 3, 4 and 5 above were in conformance with the rules of the Michigan Board of Land Surveyors or by a Decree of a Court of Law; established, re-established, monumented, re-monumented, recovered, found as expressed below:

	A	B	C	D	E	F	G	H	I	J	K	L	M
1													
2	6	5	4	3	2	1							
3													
4	7	8	9	10	11	12							
5													
6	18	17	16	15	14	13							
7													
8	19	20	21	22	23	24							
9													
10	30	29	28	27	26	25							
11													
12	31	32	33	34	35	36							
13													

NOTE: Not more than 4 corners, all in the same town and range, may be recorded on this certificate.

A. Description of original monument and accessories and/or subsequent restoration:

- December 1837, Noah Brookfield, Deputy Surveyor, GLO Notes**
Set Post in true line
Pine 16" S11°E 12 links
Beech 9" N22°W 15 links
- 1856, H.M. Caulkins, from R.D. McNutt's Index Cards, #28, 9-8**
White Oak 12" S15-1/2°W 91 links
White Oak 22" N62°E 85 links
- 1963, G.M. Stevenson from R.D. McNutt's Index Cards #28, 9-8**
Found Iron Pipe with stones and concrete chips around 24.6 feet East of Centerline of Blacktop
Power Pole and Nail Northwest 89.05 feet
Road Sign Post Southwest 80.60 feet
White Oak 24" East 8.15 feet
- 1977, E.J. Glaza, Jr. #9548, Survey Liber 501, Page 1260**
N20°E 13.55 feet to Nail in 8" Oak
S70°E 9.98 feet to Nail in 20" Oak
S49°E 14.72 feet to Nail in 18" Tree
- 1981, E.J. Glaza, #9548, Survey, Liber 535 Page 794**
Same data as 1977
- May 1983, R.J. Crater #16924, from Index Cards**
Record found 1/2" rod and Glaza's witnesses
October 1983, Burt Wickham, #17639 from R.J. Crater's record of notes
Centerline Youngman Road 23 feet West on Centerline Harlow Road extended
Set P.K. in Southwest side Power Pole N30°W 77.45 feet
Found nail in Westside 13" Oak N08°E 10.0 feet

ACCEPTED BY THE MONTCALM COUNTY SURVEY PEER GROUP AS THE OFFICIAL CORNER UNDER MICHIGAN PUBLIC ACT 345 OF 1990 AT A MEETING HELD 12-5-95

W. Tingley
William Tingley, PS, Chairman

Continued on Back.....

B. Description of corner evidence found and/or method applied in restoring or reestablishing corner:
Found 3/4" x 15" pipe 0.5 feet deep on old barb fence East, with 5" +/- diameter stones around and piece of concrete. No evidence of other monuments to 3 foot depth.

C. Description of monument for corner and accessories established to perpetuate locating the position of the corner:

- Set Remonumentation Corner over pipe in Monument Box.
- Set Nail and Tag in Light Pole N20°E 4.94 feet
- Set nail and Tag in Southside 24" Elm S45°E 14.66 feet
- Set Nail and Tag in Southside 24" Oak East 9.83 feet
- Found Spike in Southside Power Pole N50°W 77.66 feet

This corner is accepted as a careful and faithful perpetuation of the position of the original corner.

Signed by William G. Tingley Date 12-12-1995
Surveyor's Michigan License No. 30104

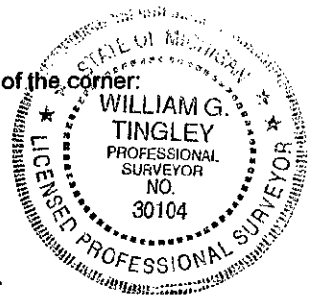

A. Continued from front (D-3, 9-8)

January 1984, Charles Fricke #21781, Survey, Liber 566, Page 115-1-6

P.K. nail Southwest Side Power Pole	Northwest	77.44 feet
P.K. nail Northeast Side 18" Elm	Southeast	14.58 feet
Property Iron	East	33.00 feet

October 1989, W.G. Tingley, #30104, Recorded LCRC, Liber 2, Page 265

Found 3/8" Steel Rod 23.20 feet East of extended Centerline

Spike in 24" Elm	S45°E	14.20 feet
Oak 24"	S85°E	8.64 feet
Property Stake	East	33.00 feet
Power Pole	N55°W	76.75 feet

December 1993, W.R. Griffin, #38933, Liber 712, Page 279

Same as above.