

JAN 17 1996

MONTCALM COUNTY REMONUMENTATION PROGRAM

COMMISSION

LAND CORNER RECORDATION CERTIFICATE

Filing Requirement of Act 74, Mich. P.A. 1970

For corners in Montcalm (County) Located In: Eureka Township Corner Code # _____

1. Public Land Survey Sec 15 T 9 N R 8 W I-6 E 1/4
 T _____ R _____
 T _____ R _____
 T _____ R _____

2. Property Controlling in Section S _____ T _____ R _____
 S _____ T _____ R _____

3. Miscellaneous Property in Sec. S _____ T _____ R _____
 S _____ T _____ R _____

STATE OF MICHIGAN
 MONTCALM COUNTY
 RECORDED
 20 DEC 95 11:37 A.M.
 VIRGINIA L. KNEPPER
 REGISTER OF DEEDS
 Register of Deeds Stamp & File Number

4. Lot No. _____, Recorded Plat _____
 5. Private Claims _____

I, William Tingley a field survey on February 10, 1995

do hereby certify that under requirements of P.A. 74, Michigan P.A. of 1970, the corner points mentioned in lines 1 and 2 above were in conformance with regulations and rules therefore as required in the current manual of survey instructions of the United States Department of the Interior, Bureau of Land Management or by a decree of a Court of Law and/or that the corner points mentioned in lines 3, 4 and 5 above were in conformance with the rules of the Michigan Board of Land Surveyors or by a Decree of a Court of Law; established, re-established, monumented, re-monumented, recovered, found as expressed below:

NOTE: Not more than 4 corners, all in the same town and range, may be recorded on this certificate.

	A	B	C	D	E	F	G	H	I	J	K	L	M
2	6	5	4	3	2	1							
3													
4	7	8	9	10	11	12							
5													
6	18	17	16	15	14	13							
7													
8	19	20	21	22	23	24							
9													
10	30	29	28	27	26	25							
11													
12	31	32	33	34	35	36							
13													

A. Description of original monument and accessories and/or subsequent restoration:
 November 29, 1837, Noah Brookfield, Deputy Surveyor, GLO Notes

- Set Post
 - White Oak 20" S11°W 14 links
 - White Oak 18" S46°E 23 links
- Unknown Date, H.M. Caulkins Notes, Page 12
 - 1" Iron Rod
- April 1913, E.D. Youdan, Notes, Page 46
 - Found 1" Iron Rod
 - New Bearing Trees:
 - Hard Maple 11" S66°W 57 feet 9 inches
 - Soft Maple 12" S40-3/4°W 29 feet 6 inches
 - White Oak 10" N60-1/4°E 77 feet 6 inches

- R.D. McNutts, Index Cards, 9-8, #51
 - 1" Iron Rod
 - White Oak 10" S11°W 14 links
 - White Oak 18" S46°E 23 links
 - 10-27 Iron Stone
 - Oak 12" N68°E 77.1 feet
 - Maple 12" S38°E 29.2 feet
 - Maple 10" S66.5°W 57.2 feet

ACCEPTED BY THE MONTCALM COUNTY SURVEY PEER GROUP AS THE OFFICIAL CORNER UNDER MICHIGAN PUBLIC ACT 345 OF 1990 AT A MEETING HELD 12-5-95.

WGT
 William Tingley, PS, Chairman

Continued on Bank

B. Description of corner evidence found and/or method applied in restoring or reestablishing corner:

- Found capped iron in Monument Box in Centerline Fairplains Street, nothing found below.
- Found nail in Southside of Youdan 1913 Bearing Tree N60°E 77.80 feet

C. Description of monument for corner and accessories established to perpetuate locating the position of the corner:
 Set Remonumentation Corner in Monument Box in place of 1/2" rerod.

- Nail in Southside 37" White Oak N60°E 77.80 feet
- Nail in Northeast side Power Pole N60°W 82.72 feet
- Northeast Corner Building Foundation S10°W 64.66 feet
- Nail in Power Pole S40°E 38.29 feet
- Hydrant (top center) N45°W 32.35 feet

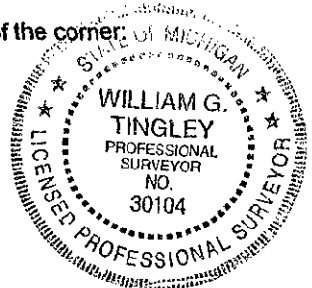

This corner is accepted as a careful and faithful perpetuation of the position of the original corner.

Signed by William G. Tingley Date 12-12, 1995
 Surveyor's Michigan License No. 30104

A. Continued from front page (1-6, 9-8)

June 1940, B.G.M.

Iron Pipe		
Tin Tag in Power Pole	N69°W	64.97 feet
Tin Tag in 20" Maple	S64°30'W	57.06 feet
Tin Tag in 24" Walnut	S2°30'E	65.55 feet
Tin Tag in 24" Oak	N65°30'E	79.96 feet

1973, Montcalm County Road Commission Index Cards

1" Iron, Boat Spike on top (1973)

Northeast corner building	S5°W	82.75 feet
Southwest corner building	S40°W	105.35 feet
Consumers Power Pole	N65°W	68.36 feet
Michigan Bell Telephone Pole	S20°W	35.61 feet

September 1977

Found same

June 1973, F.E. Spicer, #7877, Liber 475, Page 303

1" Iron

Northeast corner building	S5°W	82.75 feet
Northwest corner building	S40°W	105.35 feet
Power Pole	N66°W	68.36 feet
Telephone Pole	S20°W	35.61 feet

June 1973, F.E. Spicer, #7877, Liber 1, Page 95, recorded LCRC

Same as above

August 1984, Burt Wickham, #17889, Liber 592, Page 1279, recorded survey

Round 1/2" Rerod in Mon Box

"Nail" in East side Power Pole	S10°W	35.65 feet
PK in West side Power Pole	S35°E	37.63 feet
Centerline Top Hydrant	N50°W	32.45 feet

January 1985, A.L. Meyer #15406, Liber 580, Page 562, recorded survey

Found rebar in Mon Box

Northeast corner building	S5°W	82.82 feet
Northwest corner building	S45°W	105.28 feet
Top Centerline hydrant	N35°W	32.45 feet
Nail in side 24" Oak	N65°E	77.88 feet

January 1985, A.L. Meyer, #15406, Liber 2, page 78, Recorded LCRC

Same as above