

SURVEY & REMONUMENTATION

FEB 19 1998

MONTCALM COUNTY REMONUMENTATION PROGRAM

LAND CORNER RECORDATION CERTIFICATE

Filing Requirement of Act 74, Mich. P.A. 1970

STATE OF MICHIGAN
MONTCALM COUNTY
RECORDED

SECTION

26 Dec 1997 3:41:48 PM

LORI A. WILSON
REGISTER OF DEEDS

For corners in	Located In:	Corner Code #
<u>Montcalm</u> (County)		
1. Public Land Survey	Sec 34 T 10N R 5W T 9N R 5W T _____ R _____ T _____ R _____	<u>H-13</u> S 1/4 H-1
2. Property Controlling in Section	S _____ T _____ R _____ S _____ T _____ R _____	
3. Miscellaneous Property in Sec.	S _____ T _____ R _____ S _____ T _____ R _____	
4. Lot No. _____, Recorded Plat _____		
5. Private Claims _____		

Register of Deeds Stamp & File Number

I, William Tingley a field survey on July 28th, 1997 do hereby certify that under requirements of P.A. 74, Michigan P.A. of 1970, the corner points mentioned in lines 1 and 2 above were in conformance with regulations and rules therefore as required in the current manual of survey instructions of the United States Department of the Interior, Bureau of Land Management or by a decree of a Court of Law and/or that the corner points mentioned in lines 3, 4 and 5 above were in conformance with the rules of the Michigan Board of Land Surveyors or by a Decree of a Court of Law; established, re-established, monumented, re-monumented, recovered, found as expressed below:

NOTE: Not more than 4 corners, all in the same town and range, may be recorded on this certificate.

A. Description of original monument and accessories and/or subsequent restoration:

1831, Robert Clark, Jr., Deputy Surveyor, GLO Notes

One Quarter Section Post

Beech 10" N60°E 44 links

Beech 9" N65-1/2°W 26 links

1875, F.A. Palmer, Deputy County Surveyor

Found one old bearing tree, made new one:

Elm 2" N71°W 51 links

1968, Patrick Salisbury in Consumers Power Survey

Found stone raised with 3/8" rod (calls it N 1/4 Post of Section 3 but uses it to set 1/16 Corner in Southeast 1/4 of Section 34, 10-5)

10" Twin White Oak N15°E 75.0 feet

24" Maple S20°W 63.0 feet

1991, W.G. Tingley #30104, Survey #91051

Found 1/2" Rerod

Street Sign Post N45°W 39.10 feet

Found Nail in Westside Power Pole S45°E 46.72 feet

Westerly Leg Road Sign South 21.20 feet

nail in Westside 18" Twin Oak N40°E 75.37 feet

1994, W.G. Tingley 30104, Survey #93559

Same corner for North 1/2 Section 3, 9-5

ACCEPTED BY THE MONTCALM COUNTY SURVEY PEER GROUP AS THE OFFICIAL CORNER UNDER MICHIGAN PUBLIC ACT 345 OF 1990 AT A MEETING HELD 7-31-97

W. Tingley
William Tingley, PS, Chairman

SALISBURY DATA

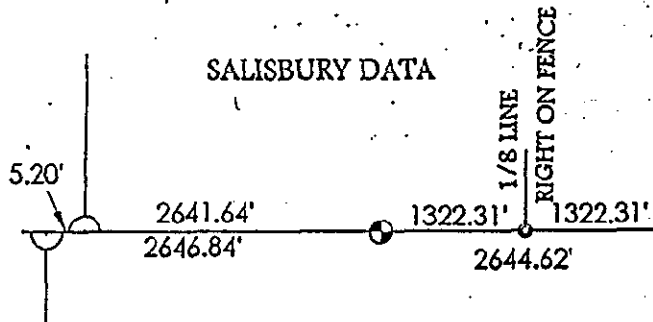

B. Description of corner evidence found and/or method applied in restoring or reestablishing corner:

Found 1/2" rerod leaning over point of stone

Found nail in west side power pole S55°E 46.82 feet

Street and Stop sign post N45°W 39.57 feet

Westerly leg arrow sign S5°W 20.73 feet

Found nail west side 36" twin oak N35°E 75.21 feet

C. Description of monument for corner and accessories established to perpetuate locating the position of the corner:

Set standard remonumentation corner

Set nail and tag #30104 west side 30" oak N30°E 87.54 feet

Found nail in west side power pole S55°E 46.82 feet

Street and Stop sign post N45°W 39.57 feet

Westerly leg arrow sign S5°W 20.73 feet

This corner is accepted as the best available evidence of the position of the original corner.

Signed by William G. Tingley Date 7/31, 1997

Surveyor's Michigan License No. 30104

FORM APPROVED BY MICHIGAN STATE BOARD OF LAND SURVEYORS

