

MONTCALM COUNTY REMONUMENTATION PROGRAM
LAND CORNER RECORDATION CERTIFICATE
 Filing Requirement of Act 74, Mich. P.A. 1970

For corners in Montcalm Located In: Crystal Township Corner Code # _____
 (County)

1. Public Land Survey Sec. 1 T 10N R 5W K-1
 and 2 _____
 T _____ R _____
 T _____ R _____

2. Property Controlling S _____ T _____ R _____
 in Section S _____ T _____ R _____

3. Miscellaneous S _____ T _____ R _____
 Property in Sec. S _____ T _____ R _____

4. Lot No. _____, Recorded Plat _____

5. Private Claims _____

STATE OF MICHIGAN
 MONTCALM COUNTY
 RECORDED

11/14/1996 4:02:54 PM

VIRGINIA L. KNEPPER
 REGISTER OF DEEDS

Register of Deeds Stamp & File Number

1	A	B	C	D	E	F	G	H	I	J	K	L	M
2	6	5	4	3	2	1							
3													
4	7	8	9	10	11	12							
5													
6	18	17	16	15	14	13							
7													
8	19	20	21	22	23	24							
9													
10	30	29	28	27	26	25							
11													
12	31	32	33	34	35	36							
13													

I, William Tingley a field surveyor on March 22, 1995, do hereby certify that under requirements of P.A. 74, Michigan P.A. of 1970, the corner points mentioned in lines 1 and 2 above were in conformance with regulations and rules therefore as required in the current manual of survey instructions of the United States Department of the Interior, Bureau of Land Management or by a decree of a Court of Law and/or that the corner points mentioned in lines 3, 4 and 5 above were in conformance with the rules of the Michigan Board of Land Surveyors or by a Decree of a Court of Law; established, re-established, monumented, re-monumented, recovered, found as expressed below:

NOTE: Not more than 4 corners, all in the same town and range, may be recorded on this certificate.

A. Description of original monument and accessories and/or subsequent restoration:
 1837, O. Risdon, Deputy Surveyor, GLO Notes
 Set Post Section 1 and 2 One Chain 63 links East of 1/4 Post
 Black Ash 10" S27°E 28 links
 Beech 10" S18°W 28 links
 1879, F.A. Palmer, County Surveyor, Field Notes, Book 1, Page 133
 Found Corner and Set a Stone and Pieces of Broken Plate
 February 20-22, 1899, Henry M. Caulkin, County Surveyor, Book 2 Page 78
 Found Stone and Crockery by F.A. Palmer, 1879
 Took New Bearing Tree: Red Oak 3" (no mark) S60°E 55 links
 July 1, 1925, Michigan State Highway Dept, M-43, Project 11, Station 590+
 Common Corners to 1 and 2 Crystal Township, not located
 December 12, 1979, Jerry Jones #19838 (Recorded Liber 1, Page 498, Liber 594, Page 501
 Found Nail over Large Stone
 Spike in Power Pole Southwest 60.70 feet
 Spike in 18" Hickory North 58.85 feet
 West Leg Stop Sign Southeast 50.40 feet
 September 18, 1992, W.G. Tingley #30104
 Found Railroad Spike in Monument Box
 Found Spike in 18" Hickory North 58.85 feet
 Set Nail and Tag Northwest side Power Pole Southwest 59.76 feet
 Found Nail Northside Wood Post Northwest 40.70 feet
 Southwest Corner Curb Return S20°E 68.95 feet

ACCEPTED BY THE MONTCALM COUNTY SURVEY PEER GROUP AS THE OFFICIAL CORNER UNDER MICHIGAN PUBLIC ACT 345 OF 1990 AT A MEETING HELD 10/8/96

WGT
 William Tingley, PS, Chairman

B. Description of corner evidence found and/or method applied in restoring or reestablishing corner:
 Found Railroad Spike in Monument box 107.40 feet East of South 1/4 Corner of Section 36, T11N-R5W

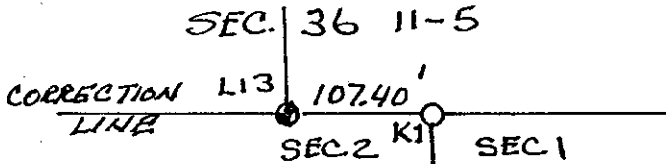

C. Description of monument for corner and accessories established to perpetuate locating the position of the corner:
 Set Remonumentation Corner in Place of spike in Monument Box
 Found Spike in 18" Hickory North 58.85 feet
 Set Nail and Tag Northwest side Power Pole Southwest 59.76 feet
 Found Nail Northside Wood Post Northwest 40.70 feet
 Southwest Corner Curb Return S20°E 68.95 feet

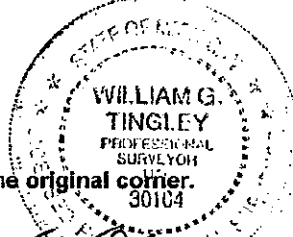

This corner is accepted as a careful and faithful perpetuation of the position of the original corner.

Signed by William G. Tingley Date 10/8/96
 Surveyor's Michigan License No. 30104