

MICHIGAN
DEPARTMENT OF CONSERVATION
~~FORESTRY DIVISION~~
Reg. III Surveyor
LAND CORNER RECORD

7-3

T. 10 N.R. 6W

Monroeton COUNTY

DESCRIPTION OF CORNER ^(Recovered) Well point - (top 12" Broken off) 3/4" in center 6" Below Grade

CORNER MONUMENT 1/4 Cor. Common Sec 2 & Sec 11

DATE MONUMENT ^{Recovered} ~~PLACED~~ AND WITNESSED Aug 24, 1966

WITNESSES TO CORNER..... Spike & tag Telephone Pole N55°W 45.4'

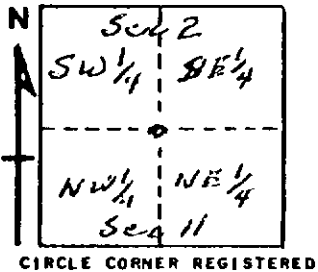

Spike & tag 4" Maple N17°W 63.0'

Spike & tag Corner Apple tree N12°E 41.4'

AND Spike & tag 14" Poplar S0°W 37.3

DESCRIPTION IN DETAIL AS TO HOW CORNER WAS LOCATED AND IDENTIFIED OR RESTORED.

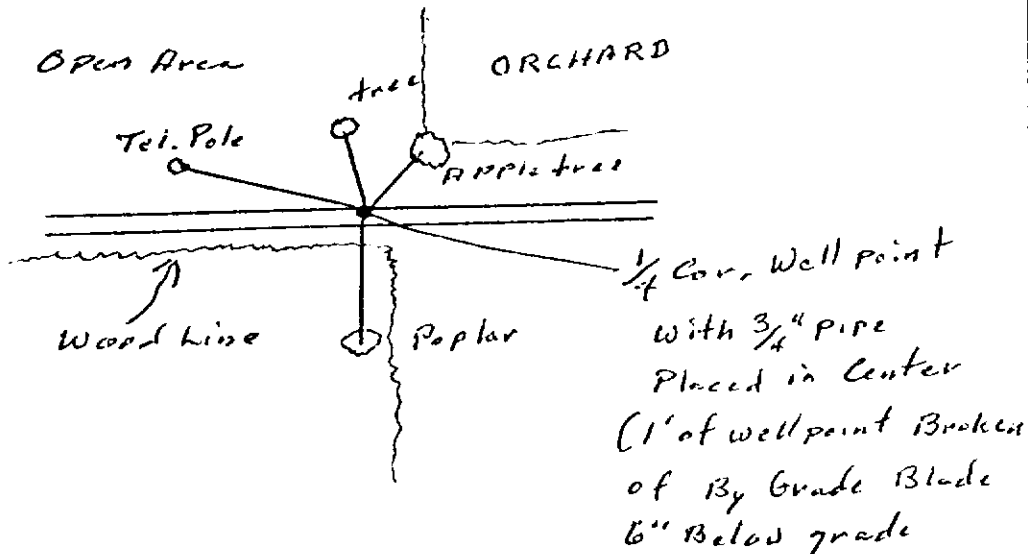

SURVEYOR'S SEAL

SIGNED [Signature] DATE 24 Aug 66
REGISTERED LAND SURVEYOR