

MONTCALM COUNTY REMONUMENTATION PROGRAM

JAN 17 1996

LAND CORNER RECORDATION CERTIFICATE

COMMISSION

Filing Requirement of Act 74, Mich. P.A. 1970

STATE OF MICHIGAN
MONTCALM COUNTY
RECORDED

20 DEC 95 11:40 A.M.

VIRGINIA L. KNEPPER
REGISTER OF DEEDS

For corners in Montcalm (County) Located in: Pine Township Corner Code # _____

1. Public Land Survey Sec 1 T 11 N R 8 R L-3, S 1/4
 T _____ R _____
 T _____ R _____
 T _____ R _____

2. Property Controlling in Section S _____ T _____ R _____
 S _____ T _____ R _____

3. Miscellaneous Property in Sec. S _____ T _____ R _____
 S _____ T _____ R _____

Register of Deeds Stamp & File Number

4. Lot No. _____ Recorded Plat _____
 5. Private Claims _____

I, William Tingley a field survey on May 31, 1994 do hereby certify that under requirements of P.A. 74, Michigan P.A. of 1970, the corner points mentioned in lines 1 and 2 above were in conformance with regulations and rules therefore as required in the current manual of survey instructions of the United States Department of the Interior, Bureau of Land Management or by a decree of a Court of Law and/or that the corner points mentioned in lines 3, 4 and 5 above were in conformance with the rules of the Michigan Board of Land Surveyors or by a Decree of a Court of Law; established, re-established, monumented, re-monumented, recovered, found as expressed below:

NOTE: Not more than 4 corners, all in the same town and range, may be recorded on this certificate.

A. Description of original monument and accessories and/or subsequent restoration: March 20, 1839, Noah Brookfield, Deputy Surveyor, GLO Notes

Set Post

Beech 12" S72°W 9 links

Pine 20" N43°E 12 links

June 1866, H.M. Caulkin, County Surveyor, Field Book 11-8, Page 24

New Bearing Tree, Elm 12" N31-1/2°W 33 links

December, 1892, H.M. Caulkin, County Surveyor, Field Book 11-8, Page 40 and 93; also recorded survey Book 1, Page 22

Fence Post South 39 links

Also recorded in Book of Surveys 2, page 22

January 29, 1907, Field Book (new) 11-8, Page 18 and 19

J.F. Daoust located post from witness. Drove piece of Buggy Axle and took Bearing Tree

Tamarack 6" S61°E 103-1/2 feet

Also recorded in Book of Surveys #3, page 252

April 1994, Montcalm County Road Commission

Found Boat Spike

Spike in Corner Fence Post S5°E 32.15 feet

Spike in 15" Elm N70°W 56.69 feet

Spike in 12" Elm N25°E 36.24 feet

B. Description of corner evidence found and/or method applied in restoring or reestablishing corner:

Found Boat Spike, nothing below it, Montcalm County Road Commission witness agrees

Northeast Corner to North 1/4 N88°20'40"W 2602.49 feet

Northwest Corner to North 1/4 S88°05'28"E 2595.66 feet

Road bed has been filled 3 - 4 feet

J.Daoust, 1907 measured 2599.08 for midpoint

Accepted as corner.

C. Description of monument for corner and accessories established to perpetuate locating the position of the corner:

Set Remonumentation in Monument Box

Spike in Corner Fence Post S5°E 32.15 feet

Spike in 15" Elm N70°W 56.69 feet

Spike in 12" Elm N25°E 36.24 feet

Tamarack S30°E 114.7 feet

This corner is accepted as a careful and faithful perpetuation of the position of the original corner.

Signed by William Tingley Date 12-12-1995

Surveyor's Michigan License No. 30104

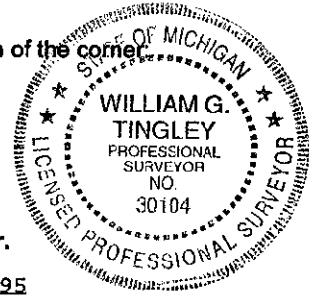

FORM APPROVED BY MICHIGAN STATE BOARD OF LAND SURVEYORS, JAN. 21, 1971
 REVISED MAY 14, 1975
 REVISED JAN., 1983
 ADAPTED FOR WORD PROCESSING MARCH, 1993

ACCEPTED BY THE MONTCALM COUNTY SURVEY PEER GROUP AS THE OFFICIAL CORNER UNDER MICHIGAN PUBLIC ACT 345 OF 1990 AT A MEETING HELD 12.5.95

WGT
 William Tingley, PS, Chairman