

JAN 17 1996

MONTCALM COUNTY REMONUMENTATION PROGRAM

LAND CORNER RECORDATION CERTIFICATE

COMMISSION

Filing Requirement of Act 74, Mich. P.A. 1970

For corners in <u>Montcalm</u> (County)	Located In:	Corner Code #
	Day Township	
1. Public Land Survey	Sec 9 T <u>11</u> N R <u>6</u> W	<u>E-5, SW Cor</u>
	T _____ R _____	_____
	T _____ R _____	_____
	T _____ R _____	_____
2. Property Controlling in Section	S _____ T _____ R _____	_____
	S _____ T _____ R _____	_____
3. Miscellaneous Property in Sec.	S _____ T _____ R _____	_____
	S _____ T _____ R _____	_____
4. Lot No. _____, Recorded Plat _____		
5. Private Claims _____		

STATE OF MICHIGAN  
MONTCALM COUNTY  
RECORDED

20 DEC 95 11:40 A.M.

VIRGINIA L. KNEPPER  
REGISTER OF DEEDS

Register of Deeds Stamp & File Number

1	A	B	C	D	E	F	G	H	I	J	K	L	M
2		6	5	4	3	2	1						
3													
4		7	8	9	10	11	12						
5													
6		18	17	16	15	14	13						
7													
8		19	20	21	22	23	24						
9													
10		30	29	28	27	26	25						
11													
12		31	32	33	34	35	36						
13													

I, William Tingley a field survey on 1994, do hereby certify that under requirements of P.A. 74, Michigan P.A. of 1970, the corner points mentioned in lines 1 and 2 above were in conformance with regulations and rules therefore as required in the current manual of survey instructions of the United States Department of the Interior, Bureau of Land Management or by a decree of a Court of Law and/or that the corner points mentioned in lines 3, 4 and 5 above were in conformance with the rules of the Michigan Board of Land Surveyors or by a Decree of a Court of Law; established, re-established, monumented, re-monumented, recovered, found as expressed below:

NOTE: Not more than 4 corners, all in the same town and range, may be recorded on this certificate.

A. Description of original monument and accessories and/or subsequent restoration:  
1837, John Milroy, Deputy Surveyor, GLO Notes

Set post

Birch 23" S35°W 36 links  
Elm 11" N22°E 24 links

1937 Art Dell, with County Road Department (R D McNutt, Co., Surveyor records)

Elm 15" SE 76.5 feet  
Oak 20" SW 138.8 feet  
Elm 6" SW 103.9 feet

B. Description of corner evidence found and/or method applied in restoring or reestablishing corner:

Found metal bar above cedar stake with boat spike in center, 3 feet below surface. Found bricks and glass around cedar stake. Agreeing with concrete monument of Plat corner (Village of McBride). Also found 1/2" Rod 7.92 feet North. Nothing under 1/2" Rerod.

Held cedar stake and boat spike as corner.

ACCEPTED BY THE MONTCALM COUNTY SURVEY PEER GROUP AS THE OFFICIAL CORNER UNDER MICHIGAN PUBLIC ACT 345 OF 1990 AT A MEETING HELD 12-5-95.

WGT  
William Tingley, PS, Chairman

C. Description of monument for corner and accessories established to perpetuate locating the position of the corner of the

Set Remonumentation corner over Cedar Stake.

Nail and Tag	Power Pole	S40°W	43.95 feet
Nail	Power Pole	N35°E	64.81 feet
Nail and Tag	Power Pole	N20°E	105.58 feet
Top Center Concrete ROW Marker	S45°E	57.65 feet	
1/2 Inch Iron	North	7.52 feet	

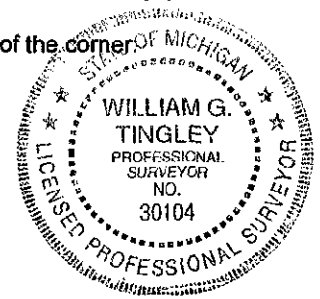

This corner is accepted as a careful and faithful perpetuation of the position of the original corner.

Signed by William Tingley Date 12-12-1995

Surveyor's Michigan License No. 30104