

SURVEY & REMONUMENTATION

JAN 17 1996

MONTCALM COUNTY REMONUMENTATION PROGRAM

LAND CORNER RECORDATION CERTIFICATE

COMMISSION

Filing Requirement of Act 74, Mich. P.A. 1970

For corners in Montcalm Located In: Pierson Township Corner Code # _____
 (County)

1. Public Land Survey Sec 6 T 11 N R 10 W C-3, SE Corner
 T _____ R _____
 T _____ R _____
 T _____ R _____

2. Property Controlling S _____ T _____ R _____
 in Section S _____ T _____ R _____

3. Miscellaneous S _____ T _____ R _____
 Property in Sec. S _____ T _____ R _____

4. Lot No. _____ Recorded Plat _____

5. Private Claims _____

STATE OF MICHIGAN
 MONTCALM COUNTY
 RECORDED

20 DEC 95 11:37 A.M.

VIRGINIA L. KNEPPER
 REGISTER OF DEEDS

Register of Deeds Stamp & File Number

I, William Tingley a field survey on June 2, 1994
 do hereby certify that under requirements of P.A. 74, Michigan P.A. of 1970, the corner points mentioned in lines 1 and 2 above were in conformance with regulations and rules therefore as required in the current manual of survey instructions of the United States Department of the Interior, Bureau of Land Management or by a decree of a Court of Law and/or that the corner points mentioned in lines 3, 4 and 5 above were in conformance with the rules of the Michigan Board of Land Surveyors or by a Decree of a Court of Law; established, re-established, monumented, re-monumented, recovered, found as expressed below:

NOTE: Not more than 4 corners, all in the same town and range, may be recorded on this certificate.

A. Description of original monument and accessories and/or subsequent restoration:
 September 25, 1837, Abner E. VanNess, Deputy Surveyor, GLO Notes

Set Post
 Maple 10" S69°E 14 links
 Maple 12" N41°E 18 links
 October 28, 1882, F.A. Palmer, Book 1, Page 283
 Found roots of both trees and this corresponded with statement of old settlers that the old stake stood near there before the road was graded up.
 Made new bearings: Pine 24" N41°W 52 links
 Pine 22" N57°E 100 links

January 1890, H.M. Caulkins, Deputy Surveyor, Book 1, Page 445
 Found Palmer's new bearing tree of 1882 -- Pine stump 24" N41°W 52 links

May 1898, H.M. Caulkins, Deputy Surveyor, Book 1, Page 68.
 Found Northwest corner of Section as perpetuated by F.A. Palmer in 1882.
 Set White Oak stake 2 rods South and took New Bearing Tree: White Oak 4" (no mark) N29-1/2°E 23-1/2 links
 May 1907, J.F. Daoust, County Surveyor, Field Notes page 62 and 63
 Located corner from Stump of new bearing tree (corner came in cut)
 Oak 4" N29-1/2°E 23-1/2 links (same came in cut) Also found stake 48 links South
 Drove Stake and Set stones around it
 New Bearing Trees: Oak 7" S26°E 42.5 links
 Elm 7" N81-3/4°E 100.5 links

ACCEPTED BY THE MONTCALM COUNTY SURVEY PE
 GROUP AS THE OFFICIAL CORNER UNDER MICHIG
 PUBLIC ACT 345 OF 1990 AT A MEETING HELD 7-29-94

WGT
 William Tingley, PS, Chairman

	A	B	C	D	E	F	G	H	I	J	K	L	M
1													
2	6	5	4	3	2	1							
3													
4	7	8	9	10	11	12							
5													
6	18	17	16	15	14	13							
7													
8	19	20	21	22	23	24							
9													
10	30	29	28	27	26	25							
11													
12	31	32	33	34	35	36							
13													

B. Description of corner evidence found and/or method applied in restoring or reestablishing corner:

Found 1/2" Iron Pipe per Chettleburg and Hackbardt witnesses

C. Description of monument for corner and accessories established to perpetuate locating the position of the corner:

Set Remonumentation Corner and Monument Box.
 Oak 12" S20°W 46.15 feet
 Poplar 3" N45°W 55.90 feet
 P.K. Face of Power Pole S60°W 62.25 feet
 Oak 12" S60°W 82.95 feet

This corner is accepted as a careful and faithful perpetuation of the position of the original corner.

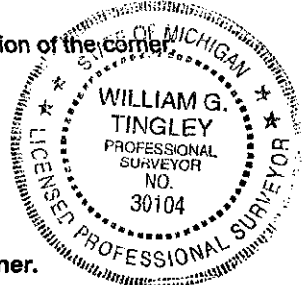

Signed by William Tingley Date 12-12-1994
 Surveyor's Michigan License No. 30104

FORM APPROVED BY MICHIGAN STATE BOARD OF LAND SURVEYORS, JAN. 28, 1971
 REVISED MAY 14, 1978
 REVISED JAN., 1983
 ADAPTED FOR WORD PROCESSING MARCH, 1993

A. C-3, Section 6, 11-10 (continued)

May 1907, J.F. Daoust, County Surveyor, Book 3, Page 278

Located corner from stump of bearing tree: Oak 4" N29-1/2°E 23-1/2 links

Also found stake 48 links South

Drove stake and set stones around.

October 1908, Notes of J.F. Daoust, page 78 and 79, Field Notes

Same as above.

April 1980, Glen S. Hackbardt, #25844, Liber 527, Page 958, also LCRC, Liber 1, page 515, Montcalm County Records

1/2" Iron

Centerline Pavement South 3 feet

Oak 12" S60°W 82.95 feet

Oak 12" S20°W 46.15 feet

Poplar 3" N43°W 55.90 feet

October 1982, Montcalm County Road Commission files

Same witnesses as above.

No date, Glen S. Hackbardt, #25844, Recorded Survey, Liber 555, Page 415, Montcalm County Records.

Same as above.

June 1983, Glen S. Hackbardt, #25844, Recorded Survey, Liber 562, Page 708 Montcalm County Records

Same as above.

October 1983, G.S. Hackbardt #25844, Recorded Survey, Liber 562, Page 710, Montcalm County Records

Same as above

May 1984, G.S. Hackbardt, #25844, Recorded Survey, Liber 585, page 1056, Montcalm County Records

Same as above.

August 1987, Jan S. Fokens, #21567, Recorded Survey, Liber 2 Page 164, Montcalm County Records

Found 1/2" Pipe in asphalt 3 feet +/- North of physical centerline of Kendaville Road.

Corner recorded in LCRC, Liber 1, Page 515, Montcalm County Records.

1/2" pipe in asphalt pavement.

North 25.75 1/2" pipe

Top Center GTE Riser Box N40°W 42.17 feet

Nail with Tag and Flag in Northeast Face Power Pole S60°W 62.25 feet

Nail with Tag and Flag in South Face 4 x 4 Mailbox post N55°E 73.85 feet

May, 1991, T.W. Chettleburgh, #16036, Liber 687, page 0241, Montcalm County Records

1/2" Iron Pipe

Center Pavement South 3 feet

Oak 12" S60°W 82.95 feet

Oak 12" S20°W 46.15 feet

Poplar 3" N45°W 55.90 feet