

SURVEY & REMONUMENTATION

AUG 31 1994

MONTCALM COUNTY REMONUMENTATION PROGRAM

Corner approved by Peer Group on _____, 1994

COMMISSION

LAND CORNER RECORDATION CERTIFICATE

Filing Requirement of Act 74, Mich. P.A. 1970

For corners in <u>Montcalm</u> (County)	Located In:	Corner Code #
1. Public Land Survey	Sec 9 T <u>12</u> R <u>5</u>	<u>G-5, SE Corn</u>
	T _____ R _____	_____
	T _____ R _____	_____
	T _____ R _____	_____
2. Property Controlling in Section	S _____ T _____ R _____	_____
	S _____ T _____ R _____	_____
3. Miscellaneous Property in Sec.	S _____ T _____ R _____	_____
	S _____ T _____ R _____	_____
4. Lot No. _____, Recorded Plat _____		
5. Private Claims _____		

STATE OF MICHIGAN
MONTCALM COUNTY
RECORDED
17 AUG 94 3:48 P.M.
VIRGINIA L. KNEPPER
REGISTER OF DEEDS
Register of Deeds Stamp & File Number

	A	B	C	D	E	F	G	H	I	J	K	L	M
1													
2	6	5	4	3	2	1							
3													
4	7	8	9	10	11	12							
5													
6	18	17	16	15	14	13							
7													
8	19	20	21	22	23	24							
9													
10	30	29	28	27	26	25							
11													
12	31	32	33	34	35	36							
13													

I, William Tingley a field survey on June 21, 1994
do hereby certify that under requirements of P.A. 74, Michigan P.A. of 1970, the corner points mentioned in lines 1 and 2 above were in conformance with regulations and rules therefore as required in the current manual of survey instructions of the United States Department of the Interior, Bureau of Land Management or by a decree of a Court of Law and/or that the corner points mentioned in lines 3, 4 and 5 above were in conformance with the rules of the Michigan Board of Land Surveyors or by a Decree of a Court of Law; established, re-established, monumented, re-monumented, recovered, found as expressed below:

NOTE: Not more than 4 corners, all in the same town and range, may be recorded on this certificate.

A. Description of original monument and accessories and/or subsequent restoration:
November 1838, Enoch Hammil, Deputy Surveyor, GLO
Set Post
Lynnwood 12" N88°W 25 links
Elm 30" S23°E 14 links
1883, F. A. Palmer, Field Book, Page 52
Found roots of Bearing Tree and point of stake (by him in previous survey)
New Bearing Tree: Pine 48" N24-1/2°W 69 links
October 1892, H.M. Caulkins, County Surveyor, Field Book, page 76
Found Palmer's New Bearing Tree of 1883 and stone
New Bearing Tree: Pine 24" N10°W 69 links
November 1895, H.M. Caulkin, County Surveyor, Book 2, Page 46
Found Bottom of stake
New Bearing Tree: Pine Stump 24" N26-1/2°E 89 links
Put down 3/4" Iron Pipe, 2 feet 8 inches long
April 1900, H.M. Caulkin, County Surveyor, Book 3, Page 18
Found stone and Palmer's pine stump
April 1905, J.F. Daoust, County Surveyor, Book 4, Page 142
Found Stone
New Bearing Tree: Pine 48" N24-1/2°W 69 links (now stump)
December 1975, D.B. Whittier, No. 10070, Liber 1, Page 298, LCRC, Recorded Montcalm County Register of Deeds
Found 1" Iron Shaft in side of 2" pipe in Monument Box -- Crystal and Tamarack Roads
N30°E to North end of CMP culvert 48.4 feet
N70°W to West end of Concrete Tile Culvert 41.8 feet

ACCEPTED BY THE MONTCALM COUNTY SURVEY PEER GROUP AS THE OFFICIAL CORNER UNDER MICHIGAN PUBLIC ACT 345 OF 1990 AT A MEETING HELD 29 July 94
William Tingley
William Tingley, PS, Chairman

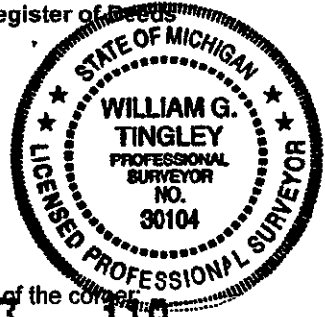

B. Description of corner evidence found and/or method applied in restoring or reestablishing corner:
Found 1" Iron Stake in 2" Iron Pipe in Monument Box
Found 1" Iron Stake 19" long 1.1 feet below surface
Found pointed stone along side Iron Stake (15" x 7" x 10")

C. Description of monument for corner and accessories established to perpetuate locating the position of the corner:
Set Remonumentation Corner and Monument Box over stone
Pine 14" S25°E 161.90 feet
Northwest Corner concrete base 4' x 7.7' stone bell stand S30°E 104.10 feet
Northwest Corner of Foundation of North wing church building S50°E 136.15 feet
North leg Stop Sign S60°W 51.62 feet

LIBER 3 PAGE 119

This corner is accepted as a careful and faithful perpetuation of the position of the original corner.

Signed by William Tingley Date 29 July, 1994

Surveyor's Michigan License No. 30104