

MAY 07 1997

COMMISSION

MONTCALM COUNTY REMONUMENTATION PROGRAM  
 LAND CORNER RECORDATION CERTIFICATE  
 Filing Requirement of Act 74, Mich. P.A. 1970

STATE OF MICHIGAN  
 MONTCALM COUNTY  
 RECORDED

11/14/1996 4:08:57 PM

VIRGINIA L. KNEPPER  
 REGISTER OF DEEDS

For corners in Montcalm (County) Located In: Richland Township Corner Code # L-5

1. Public Land Survey & Sec. 12 & Sec. 13 T 12 N R 5 W \_\_\_\_\_  
 T \_\_\_\_\_ R \_\_\_\_\_  
 T \_\_\_\_\_ R \_\_\_\_\_  
 T \_\_\_\_\_ R \_\_\_\_\_

2. Property Controlling in Section S \_\_\_\_\_ T \_\_\_\_\_ R \_\_\_\_\_  
 S \_\_\_\_\_ T \_\_\_\_\_ R \_\_\_\_\_

3. Miscellaneous Property in Sec. S \_\_\_\_\_ T \_\_\_\_\_ R \_\_\_\_\_  
 S \_\_\_\_\_ T \_\_\_\_\_ R \_\_\_\_\_

4. Lot No. \_\_\_\_\_, Recorded Plat \_\_\_\_\_

5. Private Claims \_\_\_\_\_

Register of Deeds Stamp & File Number

I, William Tingley a field survey on December 20, 1995, do hereby certify that under requirements of P.A. 74, Michigan P.A. of 1970, the corner points mentioned in lines 1 and 2 above were in conformance with regulations and rules therefore as required in the current manual of survey instructions of the United States Department of the Interior, Bureau of Land Management or by a decree of a Court of Law and/or that the corner points mentioned in lines 3, 4 and 5 above were in conformance with the rules of the Michigan Board of Land Surveyors or by a Decree of a Court of Law; established, re-established, monumented, re-monumented, recovered, found as expressed below:

NOTE: Not more than 4 corners, all in the same town and range, may be recorded on this certificate.

A. Description of original monument and accessories and/or subsequent restoration:

- 1839, Enoch Hammell, Deputy Surveyor  
 West corrected between Sections 12 and 13  
 39.93 chains; Set Quarter Section Post  
 Maple 6" N27°E 13 links
- 1885, F. Palmer, County Surveyor, Liber 1, Page 315, Record of Minutes of Survey  
 At 1/4 Post 12, 13, Mr. Cunningham told me where I would find it. Found the roots of one old Bearing Tree and remains of old stake under two stones. Drove in a cedar stake and set a (stone?) with ridge around the upper end. Also several smaller stones.
- 1888, H. Caukin, County Surveyor, Liber 1, Page 410, Record of Minutes of Survey  
 Corner 40.28 chains from Southwest Corner. No description.
- 1890, E. Jones, County Surveyor, Liber 2, Page 3, Record of Minutes of Survey  
 Shows 1/4 Corner 40.20 chains East of Northwest Corner and 40.02 chains West of Northeast Corner.
- R.D. McNutt, County Surveyor, card file records  
 Stone with ridge around upper end. Small stones.
- 1978, F. Spicer #7877, LCRC, Liber 1, Page 475  
 Found 1-1/2" Iron Pipe on line of possession North and 2" Iron Pipe 32.9 feet North, accepted 1-1/2" pipe as corner.  
 Power Pole S60°W 58.65 feet  
 30" Oak N20°W 58.77 feet  
 24" Maple N60°W 28.90 feet  
 2" Iron Pipe 3.5 feet High North 32.90 feet
- 1980, A. Pierson #13039, Survey Liber 531, Page 162 and LCRC, Liber 1, Page 540  
 1-1/2" Pipe  
 30" Oak N20°W 58.77 feet  
 Power Pole S60°W 58.65 feet  
 24" Maple N60°W 28.90 feet

B. Description of corner evidence found and/or method applied in restoring or reestablishing corner:  
 Found 1-1/2" pipe located in center of East-West road on occupation line North and Power Pole Southwest. Also 1.3 feet below surface found stone with ridge around per Palmer's 1885 description with stones around. Also found 2" pipe North.

C. Description of monument for corner and accessories established to perpetuate locating the position of the corner:

- Set Remonumentation Monument in place of pipe over stone
- Set Nail and Tag in 30" Red Oak N25°W 29.37 feet
- Found Nail in Power Pole S75°W 58.70 feet
- Set Nail & Tag in Power Pole S50°E 62.28 feet
- Center 8" Maple N45°E 39.40 feet

This corner is accepted as a careful and faithful perpetuation of the position of the original corner.

Signed by William G. Tingley Date 9/24, 1996

Surveyor's Michigan License No. 30104

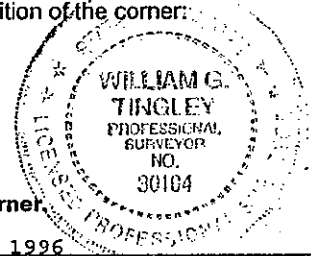

FORM APPROVED BY MICHIGAN STATE BOARD OF LAND SURVEYORS, JAN. 28, 1971

REVISED MAY 14, 1975  
 REVISED JAN., 1983

ACCEPTED BY THE MONTCALM COUNTY SURVEY BOARD AS THE OFFICIAL CORNER UNDER MICHIGAN PUBLIC ACT 345 OF 1990 AT A MEETING HELD 9/24/96

WGT  
 William Tingley, PS, Chairman