

**SURVEY & REMONUMENTATION**

DEC 15 1999

**MONTCALM COUNTY REMONUMENTATION PROGRAM**

**LAND CORNER RECORDATION CERTIFICATE**

**Filing Requirement of Act 74, Mich. P.A. 1970**

**SECTION**

For corners in

Montcalm  
(County)

Located In:

Corner Code #

Home Township

1. Public Land Survey	Sec	T <u>12N</u> R <u>6W</u>	<u>E-11</u>
		T _____ R _____	_____
		T _____ R _____	_____
		T _____ R _____	_____
2. Property Controlling in Section	S _____	T _____ R _____	_____
	S _____	T _____ R _____	_____
3. Miscellaneous Property in Sec.	S _____	T _____ R _____	_____
	S _____	T _____ R _____	_____

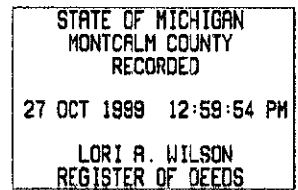

Register of Deeds Stamp & File Number

4. Lot No. \_\_\_\_\_, Recorded Plat \_\_\_\_\_  
5. Private Claims \_\_\_\_\_

I, William G. Tingley a field survey on October 27, 1998, do hereby certify that under requirements of P.A. 74, Michigan P.A. of 1970, the corner points mentioned in lines 1 and 2 above were in conformance with regulations and rules therefore as required in the current manual of survey instructions of the United States Department of the Interior, Bureau of Land Management or by a decree of a Court of Law and/or that the corner points mentioned in lines 3, 4 and 5 above were in conformance with the rules of the Michigan Board of Land Surveyors or by a Decree of a Court of Law; established, re-established, monumented, re-monumented, recovered, found as expressed below:

	A	B	C	D	E	F	G	H	I	J	K	L	M
1													
2	6	5	4	3	2	1							
3													
4	7	8	9	10	11	12							
5													
6	18	17	16	15	14	13							
7													
8	19	20	21	22	23	24							
9													
10	30	29	28	27	26	25							
11													
12	31	32	33	34	35	36							
13													

**NOTE: Not more than 2 corners, all in the same town and range, may be recorded on this certificate.**

**A. Description of original monument and accessories and/or subsequent restoration:**

November 1837, John Milroy, Deputy Surveyor, G.L.O. Notes.

North corrected between Sections 32+33

80.00 Set post corner sections 28,29,32, 33

Elm 6 N84°E 6 Links  
Beech 12 N14°W 30 Links

No Date, R.D. McNutt, County Surveyor, Note Card Record #106

Sec. Cor. 28-29-32-33

Elm 6 N74°E 6 Links  
Beech 12 N14°W 30 Links

H.M.C 1893

Pine Stp. 22

R.D.M. Iron Pin

Maple 6 S-W 42.5 Feet  
Aspen 14 S-W 42.3 Feet

No Date, G.M. Stevenson, Jr., #13600, County Surveyor, Note Card Record #139.

Sec. Cor. Sec. 28, 29, 32, 33 Home Township

1/4" Iron Rod

Sign Post S56°W 38.8 Feet  
Telephone Pole N63°W 62.4 Feet  
Telephone Pole N51°E 41.1 Feet  
Telephone Pole S18°E 82.7 Feet

(Continued on Back)

**B. Description of corner evidence found and/or method applied in restoring or reestablishing corner:**

Found 1' R.R. Spike Beside 2.4' 1" Iron Pipe in monument box over rotted wood stake and large stone.

Found Nail and Flagging Power pole S45°W 34.10 Feet  
Found Nail & Flagging Telephone Pole N45°E 54.75 Feet  
Found Nail & Flagging Telephone Pole S15°E 177.85 Feet  
Found Nail in Power pole N10°W 221.65 Feet

**C. Description of monument for corner and accessories established to perpetuate locating the position of the corner:**

Set standard remonumentation in monument box  
Set PK Nail & Tag #30104 in Power pole S45°W 34.10 Feet  
Set PK Nail & Tag #30104 in Telephone pole N45°E 54.75 Feet  
Set PK Nail & Tag #30104 in Telephone pole S15°E 177.85 Feet  
Set PK Nail & Tag #30104 in East end 15" corrugated metal pipe S40°E 63.45 Feet

This corner is accepted a careful and faithful perpetuation of the position of the original corner.

Signed by William G. Tingley Date 8-18, 1999

Surveyor's Michigan License No. 30104

ACCEPTED BY THE MONTCALM COUNTY SURVEY PEEF GROUP AS THE OFFICIAL CORNER UNDER MICHIGAN PUBLIC ACT 345 OF 1990 AT A MEETING HELD 8-18-99.

WGT  
William Tingley, PS, Chairman

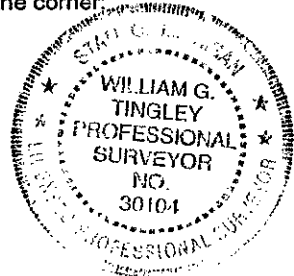

(Continued From Front Section A)

9/25/73, John R. Radcliff, #11368, L.C.R.C. Liber 1, Page 132.

T12N-R6W E-11 Fnd R.R. Spike in mon box

P.P.	N35°E	54.57 Feet
P.P.	S35°W	34.09 Feet
P.P.	N75°W	62.04 Feet

October 15, 1979, Richard J. Crater, #16924, Certificate of Survey, Liber 523, Page 216.

SE Cor. Sec. 29 T12N-R6W

(Recorded Liber 1, Page 133)

3/13/91, Stanley J. Kass, #34972, L.C.R.C. Liber 3, Page 002.

T12N-R6W E-11 Found 3/4" Rod

P.Pole (Found)	S46°W	34.09 Feet
P.Pole (Found)	N35°E	54.57 Feet
P.Pole (Set)	N07°W	222.44 Feet
P.Pole (Set)	S11°E	176.83 Feet

SURVEY &  
REMONUMENTATION

DEC 15 1999

SECTION



E4 167 45

LIBER 4

PAGE 167