

**SURVEY &
REMONUMENTATION**

**MONTCALM COUNTY REMONUMENTATION PROGRAM
LAND CORNER RECORDATION CERTIFICATE
Filing Requirement of Act 74, Mich. P.A. 1970**

SECTION _____

For corners in
Montcalm
 (County)

Located In: _____
 Home Township _____

Corner Code # _____

1. Public Land Survey	Sec	T	12N	R	6W	F-09
	21 & 28	T		R		
		T		R		
		T		R		
2. Property Controlling in Section	S	T		R		
	S	T		R		
3. Miscellaneous Property in Sec.	S	T		R		
	S	T		R		

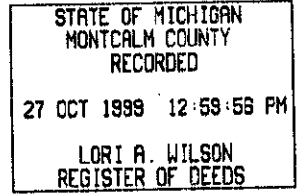

Register of Deeds Stamp & File Number

4. Lot No. _____, Recorded Plat _____
 5. Private Claims _____

	A	B	C	D	E	F	G	H	I	J	K	L	M
1													
2	6	5	4	3	2	1							
3													
4	7	8	9	10	11	12							
5													
6	18	17	16	15	14	13							
7													
8	19	20	21	22	23	24							
9													
10	30	29	28	27	26	25							
11													
12	31	32	33	34	35	36							
13													

I, William G. Tingley a field survey on October 29, 1998, do hereby certify that under requirements of P.A. 74, Michigan P.A. of 1970, the corner points mentioned in lines 1 and 2 above were in conformance with regulations and rules therefore as required in the current manual of survey instructions of the United States Department of the Interior, Bureau of Land Management or by a decree of a Court of Law and/or that the corner points mentioned in lines 3, 4 and 5 above were in conformance with the rules of the Michigan Board of Land Surveyors or by a Decree of a Court of Law; established, re-established, monumented, re-monumented, recovered, found as expressed below:

NOTE: Not more than 2 corners, all in the same town and range, may be recorded on this certificate.

- A. Description of original monument and accessories and / or subsequent restoration:
- November 1837, John Milroy, Deputy Surveyor, G.L.O. Notes.
 West corrected between 21 + 28
 39.87 1/2 (2631.42 feet) Set 1/4 Section post, 79.75 (5263.50 feet) set section corner
 Beech 8" N74°W 4 Links
 Maple 6" S62°E 23 Links
 - June 19th & 20th, 1874, F.A. Palmer, County surveyor notes, Book 1, Page 19.
 Drawing shows F09 as being 39.74 (2,622.84') east of E09 and 39.97 (2,638.02') north of F10
 Notes do not say what was found at corner
 - May 24th, 1880, F.A. Palmer, County surveyor notes, Book 1, Page 221.
 Drawing shows F09 as being 40.13 (2,648.58') west of G09
 Notes do not say what was found at corner
 - September 19th, 1881, F.A. Palmer, County surveyor note, Book 1, Page 247.
 Drawing Shows F09 as being 40.16 (2,650.56') west of G09
 Notes do not say what was found at corner

ACCEPTED BY THE MONTCALM COUNTY SURVEY PE
 GROUP AS THE OFFICIAL CORNER UNDER MICHIG.
 PUBLIC ACT 345 OF 1990 AT A MEETING HELD

William Tingley
 William Tingley, PS, Chairman

(Continued on Back. . .)

- B. Description of corner evidence found and/or method applied in restoring or reestablishing corner:
- Found "U" Shaped iron in mon box. Distance from F09 to G09 as measured on 8-9-99 is 2647.49. This being close to F.A. Palmers distance in 1880 of 40.13 chains (2648.58 feet) and in 1881 of 40.16 chains (2650.56 feet). Distances as measured by W. Tingley in 1992 was 2647.39 and by D. Wood in 1994 was 2647.42 between F-09 G09. This corner is accepted as the best available evidence of the position of the Original corner.
- | | | |
|-----------------------------------------------|-------|------------|
| Top Bolt of Hydrant | N35°W | 51.43 Feet |
| Found MSHD Nail and Tag in power pole | North | 29.60 Feet |
| Found MSHD Nail and Tag in NE side power pole | S50°E | 47.05 Feet |
| Found Ruddell nail and tag in power pole | S50°W | 83.08 Feet |

- C. Description of monument for corner and accessories established to perpetuate locating the position of the corner:
- Set standard remonumentation corner over "U" Shaped iron in mon box.
- | | | |
|-----------------------------------------------|-------|------------|
| Top Bolt of Hydrant | N35°W | 51.43 Feet |
| Found MSHD Nail and Tag in power pole | North | 29.60 Feet |
| Found MSHD Nail and Tag in NE side power pole | S50°E | 47.05 Feet |
| Found Ruddell nail and tag in power pole | S50°W | 83.08 Feet |

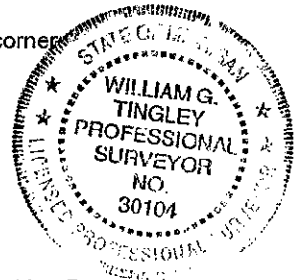

Bearings given are magnetic. Standard Monumentation consists of a Berntsen Stainless Steel 30" x 2 3/8" pipe with a Brass Cap stamped "Montcalm County Remonumentation" P.S. 30104.

Signed by William G. Tingley Date 8-18, 1999
 Surveyor's Michigan License No. 30104

SECTION

Continued from Section A.

5. August 2nd – 4th, 1898, H.M. Caulkin, County surveyor notes, Book 2, Page 71.
 Drawing shows F09 as being south 39.96 (2,637.36') of F08
 At ¼ post S. side of sec. On road bed fill 8 feet deep. Took range of both sides of Main street of Edmore ran then east to ¼ post, found at 80 ft wide. Fence post on north side appears to be placed a stake of village plat survey, east ¼ post 40 ft south of it.
6. August 12th, 1912, E.D.Y. County Surveyor, Survey Notes.
 ¼ post 21+28 – Found remains of H.M.C.s Fence post. Drove solid steel bar 1 ¼" x 24" and took N.B.T.
 Elm 8 (n.m.) N01°E 68 Feet, 10 Inches
7. No Date, R.D. McNutt, note card file #82
 ¼ post 21-28
 Beech 8" N74°W 4 Links
 Maple 6" S62°E 23 Links
 H.M.C. 1898 fence post 40 ft north
 E.D.Y. 1912 steel bar 1 ¼" x 24"
 Elm 8(n.m.) N01°E 68 Feet, 10 Inches
 Found stone and iron set by F.A. Palmer
8. No Date, County Road Commission Card, Note card file #111.
 ¼ corner 21-28 Home Township
 telephone pole S.E. 48.09 Feet
 center top of hydrant N.W. 93.29 Feet
9. 2/19/64, Norman Caldwell, #12018, Found ½" angle iron in Monument Box
 Telephone Pole S53°E 48.09 Feet
 Center Top Fire Hydrant N70°W 93.29 Feet
 Telephone Pole N06°W 29.70 Feet
10. 8/2/74, F.E. Spicer, Registration #7877, L.C.R.C., Liber 1, Page 141.
 Found "U" shaped iron in mon box and accepted as corner
 Nail-tag NE side MBT pole S50°E 48.20 Feet
 Spk NW side MBT pole S65°W 83.13 Feet
 Nail-tag SW side CP pole N05°W 29.58 Feet
11. April 14, 1978, John A. Merdzinski, Registration #10697, Certificate of Survey, Liber 512, Page 1216.
 N1/4 corner section 28, T12N-R6W "U" iron in mon box
 Nail & tag N.E. side telephone pole S50°E 48.20 Feet
 Spk. NW side telephone pole S65°W 83.13 Feet
 Nail & tag in W. Side power pole N05°W 29.58 Feet
12. May 19th, 1983, Allan L. Meyer, Registration #15406, Certificate of Survey.
 N1/4 corner – "U" iron in mon box
 Nail & tag N.E. side telephone pole S50°E 48.20 Feet
 Spk. NW side telephone pole S65°W 83.13 Feet
 Nail & tag in W. Side power pole N05°W 29.58 Feet
13. January 11th, 1988, William B. Ruddell, Certificate of Survey, Liber 613, Page 1246.
 N1/4 corner section 28 T12N-R6W, Home Township, Montcalm County, Michigan, Found mon box
 MSHD in power pole North 29.55 Feet
 MSHD in telephone pole SE 48.3 Feet
 Nail and Cap in telephone pole WSW 83.1 Feet
 Centerline fire hydrant WNW 93.4 Feet
14. January 21st, 1988, William B. Ruddell, registration #14769, L.C.R.C., Liber 2, Page 186.
 F-9 mon box
 MSHD in power pole North 29.55 Feet
 MSHD in telephone pole SE 48.3 Feet
 Nail and Cap in telephone pole WSW 83.1 Feet
 Centerline fire hydrant WNW 93.4 Feet
15. 6/10/88, Thomas J. Mueller, Registration #25861, Certificate of Survey.
 Found Monument Box
 Telephone pole SE 48.27 Feet
 Power pole North 29.57 Feet
 Telephone pole WSW 83.05 Feet
 Top centerline hydrant WNW 93.26 Feet
16. 6/17/88, Thomas J. Mueller, Registration #25861, L.C.R.C., Liber 2, Page 234.
 F-9 found monument box
 Telephone pole SE 48.27 Feet
 Power pole North 29.57 Feet
 Telephone pole WSW 83.05 Feet
 Top centerline hydrant WNW 93.26 Feet
17. 6/13/89, William G. Tingley, Registration #30104, Certificate of Survey.
 South ¼ corner, section 21, T12N-R6W,
 As recorded in L 1 Pg. 141
18. 6/24/92, William G. Tingley, Registration #30104, Certificate of Survey.
 N1/4 corner section 28, T12N-R6W, Found 1" IP in Mon Box
 MSHD in power pole North 29.55 Feet
 MSHD in telephone pole SE 48.3 Feet
 Nail and Cap in telephone pole WSW 83.1 Feet
 Centerline fire hydrant WNW 93.4 Feet
19. 5/5/94, Duane F. Wood, Registration #24625, Certificate of Survey, Liber 720, Page 698.
 North ¼ corner section 28, T12N-R6W, Found "U" shaped iron in mon box
 MSHD Tag in power pole Az. 0° 29.60 Feet
 MSHD Tag in telephone pole Az. 128° 48.25 Feet
 Top nut centerline on hydrant Az. 305° 77.99 Feet
 MSHD Tag in telephone pole Az. 256° 83.13 Feet

