

**LAND CORNER RECORDATION CERTIFICATE**  
**Filing Requirement of Act 74, Mich. P.A. 1970**

For corners in  
**MONTCALM**

(County)	Located In:	Corner Code //
1. Public Land Survey	T 12N R 7W	17
	T 12N R 7W	J6
	T R	
	T R	
2. Property Controlling in Section	S T R	
	S T R	
3. Miscellaneous Property in Sec.	S T R	
	S T R	

**Register of Deeds Stamp & File Number**

4. Lot No. \_\_\_\_\_, Recorded Plat \_\_\_\_\_  
 5. Private Claims \_\_\_\_\_

	A	B	C	D	E	F	G	H	I	J	K	L	M
2	6	5	4	3	2								
3													
4	7	8	9	10	11	12							
5													
6	18	17	16	15	14	13							
7													
8	19	20	21	22	23	24							
9													
10	30	29	28	27	26	25							
11													
12	31	32	33	34	35	36							
13													

I, **GARY C. BILOW**, in a field survey on **July 09, 1991**, 19\_\_\_\_ do hereby certify that under requirements of P.A. 74, Michigan P.A. of 1970, the corner points mentioned in lines 1 and 2 above were in conformance with regulations and rules therefore as required in the current manual of survey instructions of the United States Department of the Interior, Bureau of Land Management or by a decree of a Court of Law and/or that the corner points mentioned in lines 3, 4 and 5 above were in conformance with the rules of the Michigan Board of Land Surveyors or by a Decree of a Court of Law, established, re-established, monumented, re-monumented, recovered, found as expressed below:

**NOTE: Not more than 4 corners, all in the same town and range, may be recorded on this certificate.**

A. Description of original monument and accessories and/or subsequent restoration:  
 (17) CORNER ESTABLISHED BY U.S. GOVERNMENT DEPUTY SURVEYOR N. BROOKFIELD, 1839. ACCESSORIES: BEECH 12 N40W 10, PINE 46 S67E 12. H.M. CAUKIN NOTES IN COUNTY SURVEYOR RECORD AUG. 1887 "FD. REMAINS OF BT PINE 46 S67E 12 AND BOT. OF STAKE CORRESPONDING COURSE AND DIST. PUT DOWN STONE 14x6x6 W/GLASS AND CROCKERY". AGAIN CAUKIN NOTES IN 1902, "PUT DOWN LIGHT RR RAIL". CAUKIN'S 1887 MEASUREMENT NORTH TO 16 IS 2622.84'. HIS 1887 MEASUREMENT EAST TO J7 IS 2712.60'. HIS 1902 MEASUREMENT EAST TO J7 IS 2709.96'.  
 (J6) CORNER NOT ESTABLISHED IN ORIGINAL SURVEY. CORNER SHOWN ON PLAT OF GREEN VALLEY RESORT, RECORDED IN LIBER 9 OF PLATS PAGE 56, MONTCALM COUNTY RECORDS. FOUND NO OTHER RECORD EVIDENCE.

B. Description of corner evidence found and/or method applied in restoring or reestablishing corner:  
 (17) ORIGINAL CORNER POST AND ACCESSORIES NOT RECOVERED. CAUKIN'S MONUMENTS WERE NOT SEARCHED FOR. FOUND 1" IRON BAR IN BITUMINOUS PAVEMENT OF N-S ROAD. MY MEASUREMENTS NORTH AND EAST TO ADJACENT CORNERS ARE 2619.06' AND 2709.86' RESPECTIVELY. THESE ARE IN VERY SIMILAR PROPORTION TO CAUKIN'S 1887 MEASUREMENTS. THIS CORNER WAS LOCATED DURING A TRAVERSE OF SECTION 14 FOR A SURVEY OF THE MICHIGAN DEPARTMENT OF NATURAL RESOURCES PUBLIC ACCESS SITE ON THE SOUTH SHORE OF 5th LAKE. THE CORNER WAS NOT NECESSARY TO THE SURVEY AND IS BEING RECORDED FOR INFORMATION ONLY. I NEITHER ACCEPT NOR REJECT THIS MONUMENT AS PERPETUATING THE ORIGINAL POSITION OF 17.  
 (J6) ESTABLISHED CORNER AT THE INTERSECTION OF STRAIGHT LINES CONNECTING OPPOSITE 1/4 CORNERS, ALL AS RECORDED THIS DATE. FOUND NO MONUMENTATION AT THIS POSITION. THE LOCATION FOR J6 AS COMPUTED FROM FOUND ORIGINAL MONUMENTATION OF THE PLAT OF GREEN VALLEY RESORT AND THE RECORD DIMENSIONS SHOWN ON THE FACE OF THE PLAT, IS ABOUT 12' NORTH OF THE EAST-WEST 1/4 LINE AND APPROXIMATELY IN LINE WITH AN OLD FENCELINE EXTENDING NORTH AND SOUTH. NO MONUMENTATION WAS FOUND AT THIS POSITION AND IT WAS REJECTED AS ERRONEOUS. AT THE POSITION FOR THE CORNER, I PLACED A 1/2"x3/8" REBAR ENCASED IN A 4" DIAMETER CONCRETE CYLINDER CAPPED WITH A CAST ALUMINUM MICHIGAN DEPARTMENT OF NATURAL RESOURCES TABLET AND SET WITHIN A STANDARD CAST IRON MONUMENT BOX SET FLUSH WITH THE BITUMINOUS SURFACE OF FLECK ROAD. THE CORNER MONUMENTED FALLS IN LINE WITH THE OLD FENCE NORTH AND SOUTH.

C. Description of monument for corner and accessories established to perpetuate locating the position of the corner.  
 (17) FOUND 1" IRON BAR: EAST 2' CENTERLINE OF N-S BITUMINOUS PAVEMENT; NB1W 31.80' SET NAIL AND MDNR TAG IN NORTH FACE 34" MAPLE; SB2W 30.1' FACE OF STEEL STREET SIGN POST; NB1E 53.1' FACE OF STOP SIGN POST.  
 (J6) SET CONCRETE MONUMENT IN MONUMENT BOX: N29E 51.00' SET NAIL AND MDNR TAG IN WEST FACE 6" RED PINE; N50E 67.71' SET NAIL AND MDNR TAG IN SE FACE 8" RED PINE; S50W 36.02' SET NAIL AND MDNR TAG IN NORTH FACE 5" W. PINE; NORTH 33.00' SET CONCRETE MONUMENT WITH MDNR TABLET; NORTH 2' CENTERLINE OF FLECK ROAD; WEST 8' CENTERLINE OF GRAVEL DRIVE TO NORTH.

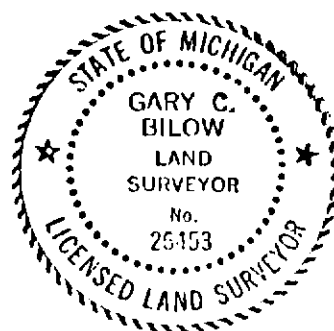

Signed by Gary C. Bilow Date 7-30-91  
 Surveyor's Michigan License No. 26453