

LAND CORNER RECORDATION CERTIFICATE
Filing Requirement of Act 74, Mich. P.A. 1970

For corners in
MONTCALM

(County)	Located In:	Corner Code //
1. Public Land Survey	T 12N R 7W	J7
	T R	
	T R	
	T R	
2. Property Controlling in Section	S T R	
	S T R	
3. Miscellaneous Property in Sec.	S T R	
	S T R	

Register of Deeds Stamp & File Number

4. Lot No. _____, Recorded Plat _____
 5. Private Claims _____

A	B	C	D	E	F	G	H	I	J	K	L	M
2	6	5	4	3	2	1						
3												
4	7	8	9	10	11	12						
5												
6	18	17	16	15	14	13						
7												
8	19	20	21	22	23	24						
9												
10	30	29	28	27	26	25						
11												
12	31	32	33	34	35	36						
13												

I, **GARY C. BILOW**, in a field survey on July 09, 1991, 19____ do hereby certify that under requirements of P.A. 74, Michigan P.A. of 1970, the corner points mentioned in lines 1 and 2 above were in conformance with regulations and rules therefore as required in the current manual of survey instructions of the United States Department of the Interior, Bureau of Land Management or by a decree of a Court of Law and/or that the corner points mentioned in lines 3, 4 and 5 above were in conformance with the rules of the Michigan Board of Land Surveyors or by a Decree of a Court of Law, established, re-established, monumented, re-monumented, recovered, found as expressed below:

NOTE: Not more than 4 corners, all in the same town and range, may be recorded on this certificate.

A. Description of original monument and accessories and/or subsequent restoration.

(J7) CORNER POST ESTABLISHED BY U.S. GOVERNMENT DEPUTY SURVEYOR N. BROOKFIELD, 1839. ACCESSORIES: BEECH 18 N41E 22, DO 12 S39W 15, H.M. CAUKIN NOTES IN COUNTY SURVEYORS RECORD IN AUG. 1887, "S1/4 COR. FND NCDT AT COR AS RE-SET BY ME 1872 AND TOOK NCBT PINE STUB 28 S21E 26". CAUKIN NOTES AGAIN IN 1902: "FLANGE OF RR RAIL AND DO 1 1/2 RODS SOUTH". CAUKIN'S MEASUREMENTS ARE 41.06 ch. WEST TO 17 AND 40 ch. EAST TO K7. CORNER RECORDED UNDER ACT 74, P.A. 1970 BY WILLIAM RUDELL IN 1986 AS FND. PIPE. RUDELL'S ACCESSORIES ARE: N 33' ROM IRON, N70E 40' N&C IN 4"x6" POST, N70W 37.78' N&C 5" SASSAFRAS.

B. Description of corner evidence found and/or method applied in restoring or reestablishing corner.

(J7) FOUND AND ACCEPTED A SECTION OF NARROW GAUGE RAILROAD RAIL SET VERTICALLY BELOW GRAVEL SURFACE. CAUKIN'S TIE TO RAIL SOUTH 1 1/2 RODS CHECKS TO A SIMILAR SECTION OF RAIL. MEASUREMENTS TO ADJACENT SECTION CORNERS ARE 2709.86' WEST AND 2640.78' EAST, AGREEING WELL WITH CAUKIN.

C. Description of monument for corner and accessories established to perpetuate locating the position of the corner.

(J7) FOUND SECTION OF RAILROAD RAIL SET VERTICALLY; N02W 33.01' FOUND T-IRON; SOUTH 24.99' FOUND SECTION OF RAILROAD RAIL SET VERTICALLY; N13W 25.8' FACE OF WOOD CORNER FENCE POST; SOUTH 3' CENTERLINE OF GRAVEL SURFACE; N70E 40.0' FND NAIL AND CAP IN 4x6 WOOD POST.

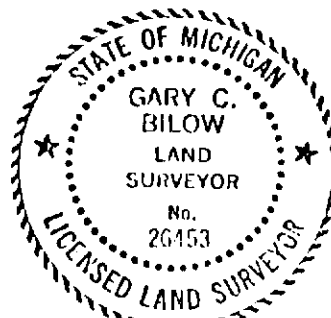

Signed by Gary C. Bilow
 Surveyor's Michigan License No. 26453

Date 9-30-91