

SURVEY & REMONUMENTATION

DEC 1 1999

MONTCALM COUNTY REMONUMENTATION PROGRAM

SECTION

LAND CORNER RECORDATION CERTIFICATE

Filing Requirement of Act 74, Mich. P.A. 1970

For corners in

Montcalm
(County)

Located In:

Reynolds Township

Corner Code #

- | | | | | |
|------------------------------------|-------|-------|-------|------|
| 1. Public Land Survey | Sec 5 | T 12N | R 10W | I-13 |
| | | T | R | |
| | | T | R | |
| | | T | R | |
| 2. Property Controlling in Section | S | T | R | |
| | S | T | R | |
| 3. Miscellaneous Property in Sec. | S | T | R | |
| | S | T | R | |

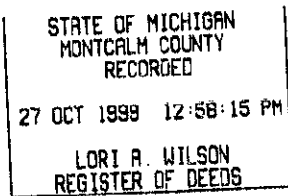

Register of Deeds Stamp & File Number

4. Lot No. _____, Recorded Plat _____
5. Private Claims _____

I, William G. Tingley a field surveyor on July 06, 1999, do hereby certify that under requirements of P.A. 74, Michigan P.A. of 1970, the corner points mentioned in lines 1 and 2 above were in conformance with regulations and rules therefore as required in the current manual of survey instructions of the United States Department of the Interior, Bureau of Land Management or by a decree of a Court of Law and/or that the corner points mentioned in lines 3, 4 and 5 above were in conformance with the rules of the Michigan Board of Land Surveyors or by a Decree of a Court of Law; established, re-established, monumented, re-monumented, recovered, found as expressed below:

NOTE: Not more than 2 corners, all in the same town and range, may be recorded on this certificate.

A. Description of original monument and accessories and/or subsequent restoration:

1. 1937, June 9th, John Hodgson, Deputy Surveyor, GLO Notes West on South Boundary Section 35, 80.00 chains set

quarter post to Sections 34 and 35.

- Beech 12" N26°E 37 links (24.24 feet)
- Beech 8" N47°W 10 links (6.6 feet)

2. 1931, June 20th, R.D. McNutt, Notes from Red Count Surveyors Book #2, Page 57, Section Corner 34-35 South Boundary, Iron pipe

Maple 6" NW 50.5 feet

3. 1943, P.V. Nelson, Survey Chief, Michigan State Highway Department, Letter to R.D. McNutt, County Surveyor, Southwest Corner section 35 found 4" square Oak Stake 1' below surface.

- Maple 6" NW 51.0 feet
- Power Pole SW 40.3 feet
- Twin Elm 6" NE 34.7 feet

4. 1984, January 13th, Glen S. Hackbardt, #25844, LCRC Liber 2 Page 49, found 1/2" rebar over other iron at road intersection. Checks to 1/8 post line and distance to east with J-13 and Maple to NW 50.5 feet.

- Rebar 1/2" West 1.58 feet
- Maple 24" N45°W 51.00 feet
- Consumers Power Pole S40°W 30 feet
- Walnut S20°W 57.6 feet (Continued on back. . .)

B. Description of corner evidence found and/or method applied in restoring or reestablishing corner:

Excavated 3'x4' and 3.5' deep hole, Found 1/2" rebar (0.25' below surface) on an angle over 1/2" rebar (0.7' below surface) that was in 1 1/2" Well point (1.25' below surface). Accepted as best available evidence of the position of the original corner.

- Found nail SE side 19" Walnut S21°W (recorded S20°W) 57.50 feet (recorded 57.6 feet)
- Found nail NW side Power Pole S40°E 30.10 feet (recorded 30.00 feet)
- Found nail NE side 33" Maple N48°W (recorded N45°W) 51.50 feet (recorded 51.00 feet)
- Found nail NE side Power Pole N10°W 81.15 feet
- T11NR10W Corner I-1 West 1.55 feet (recorded 1.58 feet)

C. Description of monument for corner and accessories established to perpetuate locating the position of the corner:

Set Standard Remonumentation Monument in place of rebar and well point.

- Found nail SE side 19" Walnut S21°W 57.50 feet
- Found nail NW side Power Pole S40°E 30.10 feet
- Found nail NE side 33" Maple N48°W 51.50 feet
- Found nail NE side Power Pole N10°W 81.15 feet
- T11NR10W Corner I-1 West 1.55 feet
- Set nail & tag NW side Power Pole N40°E 57.00 feet
- Set nail & tag NE side 6" Elm S29°E 61.95 feet

Bearings given are magnetic. Standard Monumentation consists of a Berntsen Stainless Steel 30" x 2 3/8" pipe with Brass Cap stamped "Montcalm County Remonumentation" P.S. 30104

Signed by William G. Tingley Date 7/28, 1999

Surveyor's Michigan License No. 30104

FORM APPROVED BY MICHIGAN STATE BOARD OF LAND SURVEYORS, JAN. 26, 1971
REVISED MAY 14, 1976
REVISED JAN., 1983
ADAPTED FOR WORD PROCESSING MARCH, 1993

	A	B	C	D	E	F	G	H	I	J	K	L	M
1													
2	6	5	4	3	2	1							
3													
4	7	8	9	10	11	12							
5													
6	18	17	16	15	14	13							
7													
8	19	20	21	22	23	24							
9													
10	30	29	28	27	26	25							
11													
12	31	32	33	34	35	36							
13													

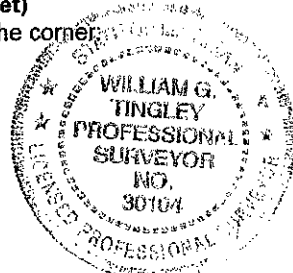

ACCEPTED BY THE MONTCALM COUNTY SURVEY PEER GROUP AS THE OFFICIAL CORNER UNDER MICHIGAN PUBLIC ACT 345 OF 1990 AT A MEETING HELD 7/28/99

WGT
William Tingley, PS, Chairman



LIBER 4

PAGE 127

E4 127 5

(Continued from section A. . .)

5. 1984, January 13th, Glen S. Hackbardt, #25844, Survey #78584, Southwest Corner Section 35 found same as LCRC.
6. 1989, October 12th, Glen S. Hackbardt, #25844, Survey #79872, Southwest Corner Section 35 found same as LCRC.
7. 1989, May 18th, Glen S. Hackbardt, #25844, Survey #79790, Southwest Corner Section 35 found same as LCRC.
8. 1989, November 6th, Glen S. Hackbardt, #25844, Survey #79872-1, Southwest Corner Section 35 found same as LCRC.
9. 1995, May 11th, William G. Tingley, #30104, Survey #95178, Southeast Corner Section 34 found ½" rerod.

SURVEY &
REMONUMENTATION

DEC 1 1999

SECTION



E4 128 6

LIBER 4

PAGE 128