

REMONUMENTATION

JAN 20 2000

SECTION

MONTCALM COUNTY REMONUMENTATION PROGRAM
LAND CORNER RECORDATION CERTIFICATE
Filing Requirement of Act 74, Mich. P.A. 1970

For corners in Montcalm (County) Located in: Winfield Township Corner Code #

1. Public Land Survey T 12 N R 09 W A-06
T 12N R 10 W M-06 ✓
T _____ R _____
T _____ R _____

2. Property Controlling in Section S _____ T _____ R _____
S _____ T _____ R _____

3. Miscellaneous Property in Sec. S _____ T _____ R _____
S _____ T _____ R _____

4. Lot No. _____ Recorded Plat _____

5. Private Claims _____

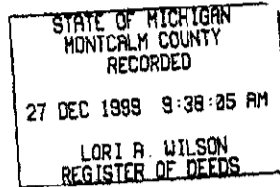

Register of Deeds Stamp & File Number

	A	B	C	D	E	F	G	H	I	J	K	L	M
1													
2	6	5	4	3	2	1							
3													
4	7	8	9	10	11	12							
5													
6	18	17	16	15	14	13							
7													
8	19	20	21	22	23	24							
9													
10	30	29	28	27	26	25							
11													
12	31	32	33	34	35	36							
13													

I, William G. Tingley in a field survey on May 24 1999 do hereby certify that under requirements of P.A. 74, Michigan P.A. of 1970, the corner points mentioned in lines 1 and 2 above were in conformance with regulations and rules therefore as required in the current manual of survey instructions of the United States Department of the Interior, Bureau of Land Management or by a decree of a Court of Law and/or that the corner points mentioned in lines 3, 4 and 5 above were in conformance with the rules of the Michigan Board of Land Surveyors or by a Decree of a Court of Law; established, re-established, monumented, re-monumented, recovered, found as expressed below:

NOTE: Not more than 2 corners, all in the same town and range, may be recorded on this certificate.

- A. Description of original monument and accessories and/or subsequent restoration:
- June 8, 1837, John Hodgson, Deputy Surveyor, GLO notes, Set quarter section post Pine 14" S72°W 17 links (11.22 feet)
 - White oak 28" N23°W 16 links (10.56 feet)
 - February 1899, R.D. McNutt Card file, Found pine stump burnt badly. Measured N72°E, 17 links (11.22 feet), found bottom of stake. NBT pine stump 22" S85°E, 47 links (31.02 feet).
 - June 26, 1907 John F. Doust, County Surveyor, Found gas pipe and stake, pine stump 18", S-E 49 1/4 links (32.51 feet)
 - May 1911, H.M. Caulkins, County Surveyor, Road surveys, found gas pipe from J.F. Doust's NBT-pine stump (2n.) S30 1/2 °E 32' 3" Took NB-fence post S2 1/2 °W 24' 2"
 - May 25, 1972, Patrick Salsbury #13534, Found boatspike in Mon. Box, Southeast face power pole N45°W 150.10', 16" white oak N07°E 115.30', 18" oak South 95.9', Recorded Liber 464, Page 27.
 - November 9, 1973, Gerald J. Gray # 17741 Found Iron Power pole N45°W 150.10 feet, 16" oak N07°E 115.30 feet, 12" oak Due south 95.90 feet.
 - 1978 M-46 Road Plans Project # 59-35, Control Section 59042, Sheet 16
 - March 26, 1979, Duane F. Wood # 24625, LCRC (Liber 002 Page 100), Found 1" steel bar in Mon. Box 8.50' north of centerline of M-46
 - December 16, 1988, William G. Tingley # 30104 Found iron, Power pole N45°W 150.10 feet
16" Oak N07°E 115.30 feet
12" Oak Due S 95.40 feet
 - June 1, 1993 James J. Keller, Found iron in Mon. Box 8.30' north of centerline M-46
Set PK nail in mail box post N80°E 47.95 feet
Set 60d nail and tag SW side 12" oak S30°E 78.22 feet
North face steel post S02°W 48.38 feet
Centerline M-46 8.30 feet

ACCEPTED BY THE MONTCALM COUNTY SURVEY PEER GROUP AS THE OFFICIAL CORNER UNDER MICHIGAN PUBLIC ACT 345 OF 1990 AT A MEETING HELD 12/22/99

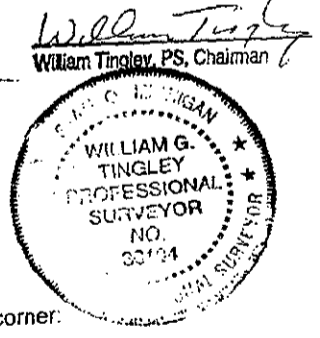

B. Description of corner evidence found and/or method applied in restoring or reestablishing corner:
Found iron in Mon. Box. 8.30 feet north of centerline of M-46

- 14" Oak S35°E 78.10 feet
- 8" Oak S58°W 73.40 feet
- 24" Twin oak N50°E 80.30 feet
- Tele. cable box N80°W 64.80 feet

C. Description of monument for corner and accessories established to perpetuate locating the position of the corner:
Did not set monument-would not fit over iron without moving the monument box.

- 14" Oak S35°E 78.10 feet
- 8" Oak S58°W 73.40 feet
- 24" Twin oak N50°E 80.30 feet
- Tele. cable box N80°W 64.80 feet

This corner is accepted as the best available evidence of the position of the original corner.

Signed by William Tingley Date 22 Dec 99
Surveyor's Michigan License No. 30104

FORM APPROVED BY MICHIGAN STATE BOARD OF LAND SURVEYORS, JAN. 24, 1971
REVISED MAY 14, 1975
REVISED JAN. 1983
ADAPTED FOR WORD PROCESSING MARCH, 1993

