

FEB 09 2000

LAND CORNER RECORDATION CERTIFICATE
Filing Requirement of Act 74, Mich. P.A. 1970

STATE OF MICHIGAN
COUNTY OF MUSKEGON
RECEIVED FOR RECORD

1999 DEC 27 PM 12: 45

Mark Fairchild
REGISTER OF DEEDS

For corners in

SECTION

Located In:

Corner Code #

Muskegon
(County)

1. Public Land Survey	T	<u>9 N</u>	R	<u>14 W</u>	<u>M-5</u>
	T		R		
	T		R		
	T		R		
2. Property Controlling In Section	S		T		
	S		T		
3. Miscellaneous Property in Sec.	S		T		
	S		T		

Register of Deeds Stamp & File Number

4. Lot No. _____, Recorded Plat _____
5. Private Claims _____

I, Stephen V. Vallier, in a field survey on November, 1999, do hereby state that under requirements of P.A. 74, Michigan P.A. of 1970, the corner points mentioned in lines 1 and 2 above were in conformance with regulations and rules therefore as required in the current manual of survey instructions of the United States Department of the Interior, Bureau of Land Management or by a decree of a Court of Law and /or that the corner points mentioned in lines 3, 4 and 5 above were in conformance with the rules of the Michigan Board of Land Surveyors or by a Decree of a Court of Law; established, re-established, monumented, recovered, found as expressed below:

NOTE: Not more than 2 corners, all in the same town and range, may be recorded on this certificate.

A	B	C	D	E	F	G	H	I	J	K	L	M
1												
2	6		5		4		3		2		1	
3												
4	7		8		9		10		11		12	
5												
6	18		17		16		15		14		13	
7												
8	19		20		21		22		23		24	
9												
10	30		29		28		27		26		25	
11												
12	31		32		33		34		35		36	
13												

A. Description of original monument and accessories and/or subsequent restoration:

1837 G.L.O. (John Mullett) set the corner posts of Sections 12 and 13.
N 58° W 45 Links 12" Hickory
S 84° W 17 Links 12" Beech

1977 C. Englert found a "T" iron, recorded L.C.R.C. in Liber 1118, Page 937.
NE 38.16' 24" Maple
NW 29.48' 36" Maple
W 21.50' St. Sign
SW 42.28' 26" Maple

1981 Ottawa County Surveyor (T. Joiner) found a "T" iron and reset with a cast-iron monument, recorded in L.C.R.C, Liber 4, Page 236, Ottawa County Records.

MARK F. FAIRCHILD
MUSKEGON COUNTY
Register of Deeds
Recorded Copy!

B. Description of corner evidence found and/or method applied in restoring or reestablishing corner:

Found a 4" cast-iron monument at the intersection of Hoover and Squires Roads. Accepted position of corner due to historical usage and documentation. Evidence that corner is the correct perpetuation of the G.L.O. corner is inconclusive.

N 40° E 38.16' 24" Maple Found nail on east side
S 40° W 43.70' 18" Maple Found nail on east side
N 70° W 29.40' 36" Maple Found nail on south side

POSITION OF SAID SW
RECORDED CORNER 8/10/99
REVIEWED & RATIFIED
BY MUSKEGON COUNTY
PEER GROUP IN ACCORDANCE
WITH P.A. 345, OF 1990

C. Description of monument for corner and accessories established to perpetuate locating the position of the corner:

Found a 4" cast-iron monument with a county surveyor's cap.
N 40° E 38.16' 24" Maple Found nail on east side
S 40° W 43.70' 18" Maple Found nail on east side
N 70° W 29.40' 36" Maple Found nail on south side
S 25° W 80.30' 16" Maple Found nail on east side

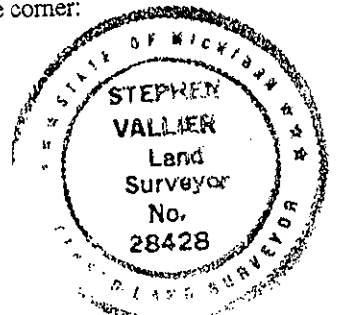

Signed by *Stephen V. Vallier*
Surveyor's Michigan License No. 28428

Date 12/22/99
FORM APPROVED BY MICHIGAN STATE BOARD OF PROFESSIONAL SURVEYORS, JAN. 28, 1
REVISED MAY 14, 1
REVISED JAN., 1
REVISED OCT., 1

A2077