

**LAND CORNER RECORDATION CERTIFICATE**

Filing Requirement of Act 74, Mich. P.A. 1970

For corners in Muskegon (County)

Located In: COMMING

Corner Code #:

- 1. Public Land Survey T 10N R 17W F-1
- 2. Property Controlling in Section S T R
- 3. Miscellaneous Property in Sec. S T R

Register of Deeds Stamp & File Number

*Comm. 11/18/76*  
 11854

- 4. Lot No. \_\_\_\_\_, Recorded Plat \_\_\_\_\_
- 5. Private Claims \_\_\_\_\_

A	B	C	D	E	F	G	H	I	J	K	L
2	6	5	4	3	2	1					
3											
4	7	8	9	10	11	12					
5											
6	18	17	16	15	14	13					
7											
8	19	20	21	22	23	24					
9											
10	30	29	28	27	26	25					
11											
12	31	32	33	34	35	36					
13											

I, Stanley Shackelford, P.S., in a field survey on October 30, 1996, do hereby certify that under requirements of P.A. 74, Michigan P.A. of 1970, the corner points mentioned in lines 1 and 2 above were in conformance with regulations and rules therefore as required in the current manual of survey instructions of the United States Department of the Interior, Bureau of Land Management or by a decree of a Court of Law and/or that the corner points mentioned in lines 3, 4 and 5 above were in conformance with the rules of the Michigan Board of Land Surveyors or by a Decree of a Court of Law; established, re-established, monumented, re-monumented, recovered, found as expressed below:

**NOTE: Not more than 4 corners, all in the same town and range, may be recorded on this certificate.**

**A. Description of original monument and accessories and/or subsequent restoration:**

- 1837 G.L.O. CORNER NOT SET
- 1950 M.C.R.C. 2" IRON PIPE 13' NORTH OF CENTERLINE ROAD
- EAST NORTHEAST 183.30' 20" W. OAK
- SOUTHEAST 46.80' TELEPHONE POLE
- SOUTHWEST 88.60' 8" JACK PINE
- WEST SOUTHWEST 90.90' 8" JACK PINE

"SEE ATTACHED EXHIBIT F-1"

**B. Description of corner evidence found and/or method applied in restoring or reestablishing corner:**

- FOUND 4" X 30" CAST IRON MONUMENT WITH COUNTY SURVEYOR LEGEND IN ASPHALT
- NORTH 59° WEST 34.18' POWER POLE FOUND SPIKE
- SOUTH 32° EAST 52.68' GUY POLE FOUND SPIKE
- SOUTH 31° WEST 77.57' 14" OAK FOUND SPIKE
- SOUTH 56° WEST 83.48' 14" PINE FOUND SPIKE
- SOUTH 11.30' CENTERLINE ASPHALT

- CHECK'S WITH SINGLE PROPORTIONATE MEASURE WITHIN 1'±
- CHECK'S WITH POSITION OF HISTORICAL USAGE
- CHECK'S WITH 1950'S POSITION NORTH OF CENTERLINE ASPHALT

POSITION OF SAID RECORDED CORNER 9/10/96  
 REVIEWED & ACCEPTED BY MURRAY WAINY PEER COUNTY SURVEYOR IN ACCORDANCE WITH P.A. 365, OF 1990

**C. Description of monument for corner and accessories established to perpetuate locating the position of the corner:**

- FOUND 4" X 30" CAST IRON MONUMENT WITH COUNTY SURVEYOR LEGEND IN ASPHALT
- NORTH 59° WEST 34.18' POWER POLE FOUND SPIKE
- SOUTH 32° EAST 52.68' GUY POLE FOUND SPIKE
- SOUTH 31° WEST 77.57' 14" OAK FOUND SPIKE
- SOUTH 56° WEST 83.48' 14" PINE FOUND SPIKE
- SOUTH 11.30' CENTERLINE ASPHALT

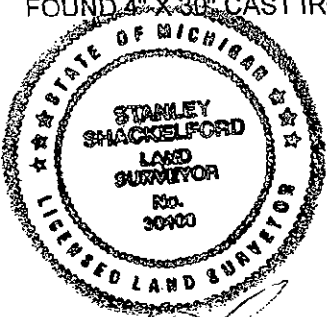

Signed by Stanley Shackelford  
 Surveyor's Michigan License No. 30100

Date 10-26-96

LIBER 1952 PAGE 842

11854

EXHIBIT F-1

LIREP 1952 PAGE 843

1987 LIBER 1411, PAGE 547 BY R. VAN RIPER  
FOUND 1" PINE CHECKED M.C.R.C. WITNESSES  
SET 4" X 36" CAST IRON MONUMENT WITH COUNTY SURVEYOR LEGEND

SOUTH 32° EAST	52.68'	SPIKE GUY POLE
SOUTH 31° WEST	77.57'	SPIKE IN 14" OAK
SOUTH 56° WEST	83.48'	SPIKE IN 14" PINE
NORTH 59° WEST	34.18'	SPIKE IN POWER POLE