

MAR 09 1999

LAND CORNER RECORDATION CERTIFICATE
Filing Requirement of Act 74, Mich. P.A. 1970

STATE OF MICHIGAN
COUNTY OF MUSKEGON
RECEIVED FOR RECORD

For corners in

SECTION

1998 DEC 28 PM 3:3

Carrie Carter
REGISTER OF DEEDS

LIBER 2189 PAGE 274

Register of Deeds Stamp & File Number

| Muskegon (County) | Located In: | Corner Code # |
|---------------------------------------|---------------------------|---------------|
| 1. Public Land Survey | T <u>11N</u> R <u>15W</u> | <u>F-9</u> |
| | T _____ R _____ | _____ |
| | T _____ R _____ | _____ |
| | T _____ R _____ | _____ |
| 2. Property Controlling In Section | S _____ T _____ R _____ | _____ |
| | S _____ T _____ R _____ | _____ |
| 3. Miscellaneous Property in Sec. | S _____ T _____ R _____ | _____ |
| | S _____ T _____ R _____ | _____ |

4. Lot No. _____, Recorded Plat _____
5. Private Claims _____

I, Stephen V. Vallier, in a field survey on December 9, 1998, do hereby state that under requirements of P.A. 74, Michigan P.A. of 1970, the corner points mentioned in lines 1 and 2 above were in conformance with regulations and rules therefore as required in the current manual of survey instructions of the United States Department of the Interior, Bureau of Land Management or by a decree of a Court of Law and /or that the corner points mentioned in lines 3, 4 and 5 above were in conformance with the rules of the Michigan Board of Land Surveyors or by a Decree of a Court of Law; established, re-established, monumented, recovered, found as expressed below:

| | | | | | | | | | | | | | |
|----|---|----|---|----|---|----|---|----|---|----|---|----|---|
| 1 | A | B | C | D | E | F | G | H | I | J | K | L | M |
| 2 | | 6 | | 5 | | 4 | | 3 | | 2 | | 1 | |
| 3 | | | | | | | | | | | | | |
| 4 | | 7 | | 8 | | 9 | | 10 | | 11 | | 12 | |
| 5 | | | | | | | | | | | | | |
| 6 | | 18 | | 17 | | 16 | | 15 | | 14 | | 13 | |
| 7 | | | | | | | | | | | | | |
| 8 | | 19 | | 20 | | 21 | | 22 | | 23 | | 24 | |
| 9 | | | | | | | | | | | | | |
| 10 | | 30 | | 29 | | 28 | | 27 | | 26 | | 25 | |
| 11 | | | | | | | | | | | | | |
| 12 | | 31 | | 32 | | 33 | | 34 | | 35 | | 36 | |
| 13 | | | | | | | | | | | | | |

NOTE: Not more than 2 corners, all in the same town and range, may be recorded on this certificate.

A. Description of original monument and accessories and/or subsequent restoration:

1837 G.L.O. set corner post.

| | | |
|-------|----------|---------------|
| N60°E | 30 links | 10" white oak |
| S35°W | 9 links | 6" white oak |

1968 C.F. Lewandowski found 1/2" iron pipe 1.5' ± above ground.

1972 C. Englert used iron pipe on survey and reset with concrete monument.

1983 C.F. Lewandowski found concrete monument and reset with 4" x 30" cast iron monument with county surveyor's cap. Recorded in L.C.R.C. in Liber 1258 Page 267.

| | | |
|-------|--------|---------|
| E | 4.9' | 12" oak |
| N30°E | 29.58' | 12" oak |
| N40°W | 24.87' | 12" oak |
| S55°W | 35.75' | 12" oak |

Nov 24, 1998

POSITION OF SAID
RECORDED CORNER
REVIEWED & RATIFIED
BY MUSKEGON COUNTY
PEER GROUP IN ACCORDANCE
WITH P.A. 345, OF 1990

B. Description of corner evidence found and/or method applied in restoring or reestablishing corner:

Found 4" x 30" cast iron monument with county surveyor's cap on recent east-west fence line (± 10 years old). Double corner found being a 1" pinched iron pipe 156' north of existing cast iron monument. All recent surveys have used corner recorded in Liber 1258 Page 267. No old boundary occupation or evidence of G.L.O. witnesses at either corner location. The position of the second corner creates a more conformed relationship to the adjacent sections. Occupation line direction used by C.F. Lewandowski to establish lost corners G-9 and H-9. Fits the position of this corner.

Acceptance of the position of the existing cast iron monument that is recorded is as follows:

- Both corners were existing found irons--both corners are unknown in origin--both corners are not supported by boundary evidence--both corners are inconclusive of G.L.O. perpetuation.
- Historical usage (from 1968 to present) supports corner currently recorded.

C. Description of monument for corner and accessories established to perpetuate locating the position of the corner:

Found 4" x 30" cast iron monument with county surveyor's cap.

| | | |
|-------|---------|---------------------------|
| N10°E | 156.50' | 1" pinched iron |
| E | 4.90' | 12" oak - nail north side |
| N30°E | 29.58' | 12" oak - nail west side |
| N40°W | 24.87' | 12" oak - nail east side |
| S55°W | 35.75' | 12" oak - nail east side |

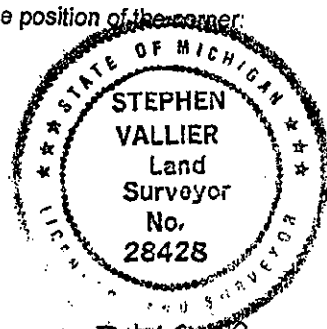

Signed by *Stephen Vallier*
Surveyor's Michigan License No. 28428

Date Dec 23 1998
FORM APPROVED BY MICHIGAN STATE BOARD OF PROFESSIONAL SURVEYORS, JAN. 28, 1
REVISED MAY 14, 1
REVISED JAN. 1

A1991