

MAR 08 1999

LAND CORNER RECORDATION CERTIFICATE
Filing Requirement of Act 74, Mich. P.A. 1970

STATE OF MICHIGAN
COUNTY OF MUSKEGON
RECEIVED FOR RECORD

For corners in SECTION

1998 DEC 28 PM 3:37

Carrie Carter
REGISTER OF DEEDS

LIBER 2189 PAGE 268

Register of Deeds Stamp & File Number

Muskegon (County)	Located In:	Corner Code #
1. Public Land Survey	T <u>11N</u> R <u>15W</u>	<u>H-9</u>
	T _____ R _____	_____
	T _____ R _____	_____
	T _____ R _____	_____
2. Property Controlling In Section	S _____ T _____ R _____	_____
	S _____ T _____ R _____	_____
3. Miscellaneous Property in Sec.	S _____ T _____ R _____	_____
	S _____ T _____ R _____	_____

4. Lot No. _____, Recorded Plat _____
 5. Private Claims _____

I, Stephen V. Vallier, in a field survey on December 9, 1998, do hereby state that under requirements of P.A. 74, Michigan P.A. of 1970, the corner points mentioned in lines 1 and 2 above were in conformance with regulations and rules therefore as required in the current manual of survey instructions of the United States Department of the Interior, Bureau of Land Management or by a decree of a Court of Law and/or that the corner points mentioned in lines 3, 4 and 5 above were in conformance with the rules of the Michigan Board of Land Surveyors or by a Decree of a Court of Law; established, re-established, monumented, recovered, found as expressed below:

NOTE: Not more than 2 corners, all in the same town and range, may be recorded on this certificate.

	A	B	C	D	E	F	G	H	I	J	K	L	M
1													
2	6	5	4	3	2	1							
3													
4	7	8	9	10	11	12							
5													
6	18	17	16	15	14	13							
7													
8	19	20	21	22	23	24							
9													
10	30	29	28	27	26	25							
11													
12	31	32	33	34	35	36							
13													

A. Description of original monument and accessories and/or subsequent restoration:

1837 G.L.O. set corner post.

S11°E 30 links 6" white oak
 N34°W 80 links 12" white oak

1968 C.F. Lewandowski set 1/2" iron rod as lost corner by single proportionate measure I-9 to F-9.

1989 Stan Shackelford replaced 1/2" iron rod with 4" x 30" cast iron monument with county surveyor's cap. Recorded in L.C.R.C. in Liber 1502 Page 552.

N89°E 25.75' 6" pine
 N 50'± Centerline of road
 SE 59.02' 6" pine
 SW 115.11' Power pole
 WSW 26.98' Power pole

POSITION OF SAID
 RECORDED CORNER
 REVIEWED & RATIFIED
 BY MUSKEGON COUNTY
 PEER GROUP IN ACCORDANCE
 WITH P.A. 345, OF 1990

Nov 24, 1998

B. Description of corner evidence found and/or method applied in restoring or reestablishing corner:

Found 2 3/4" x 30" cast iron monument with county surveyor's cap. Monument is approximately 50' south of centerline of Sweeter road. Originally set as lost corner in 1968 by single proportionate measurement from I-9 to F-9. A second corner being a 1" galvanized pipe was found 16' west of cast iron monument. Old fence to the south lies 33' west of existing county monument. Old fencing ends approximately 300' south of section line and may be evident of old grape plantings. No G.L.O. evidence existing, and origin of the galvanized pipe is uncertain. Boundary evidence is inconclusive to other corner. Accepted position of existing county monument due to recent usage and lack of any older evidence.

C. Description of monument for corner and accessories established to perpetuate locating the position of the corner:

Found 2 3/4" x 30" cast iron monument with county surveyor's cap. Approximately 50' south of centerline of Sweeter Road.

W 16.0' 1" galvanized pipe
 W 26.98' Power pole - nail north side
 S45°E 59.02' 12" pine - nail north side
 S80°W 115.11' Power pole - nail north side

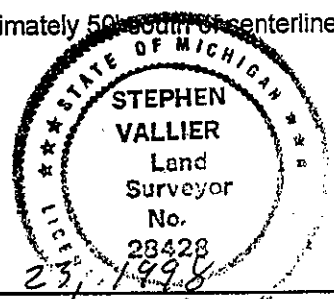

Signed by Stephen V. Vallier
 Surveyor's Michigan License No. 28428

Date Dec 23, 1998

A 1985