

MICHIGAN
DEPARTMENT OF CONSERVATION
FORESTRY DIVISION

LAND CORNER RECORD

T. 44 N.R. 23-24 W

Marquette COUNTY

DESCRIPTION OF CORNER 1/4 Corner for Sections 25-30

CORNER MONUMENT 3/8" x 24" Iron Bar buried in road

DATE MONUMENT PLACED AND WITNESSED 9-19-61 with Arne Metsa, District Forester

WITNESSES TO CORNER..... Fence Corner N 45° E 72 links

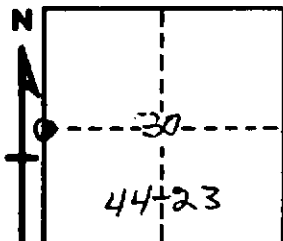

14" Power Pole S 42° E 51 1/2 links

6" Well Casing 2' high N 36° W 122 links

AND

CIRCLE CORNER REGISTERED

DESCRIPTION IN DETAIL AS TO HOW CORNER WAS LOCATED AND IDENTIFIED OR RESTORED.

This Corner was placed in Center of N-E-W road. Talked to a local resident, Mr. McFarlane, 84 years of age, who says this road has been considered the corner as long as he can remember, at least 60 years. Local fences agree with this.

SURVEYOR'S SEAL

SIGNED Billy D. Buckler DATE April 24, 1964
REGISTERED LAND SURVEYOR
Billy D. Buckler