

MICHIGAN
DEPARTMENT OF CONSERVATION
FORESTRY DIVISION

LAND CORNER RECORD

T. 44 N.R. 24 W

Marquette COUNTY

DESCRIPTION OF CORNER Section Corner Common to 9, 10, 15 and 16

CORNER MONUMENT 1-inch galvanized pipe with 4-inch brass cap

DATE MONUMENT PLACED AND WITNESSED November 9, 1961

WITNESSES TO CORNER..... Cedar 11 S 2 E 25.5 links

Cedar 12 S 65 W 41.5 links

Cedar 8 N 56 W 23.5 links

AND

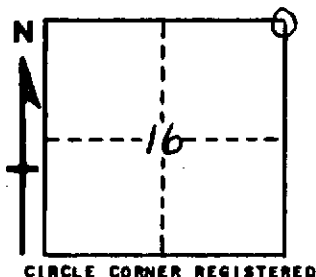

DESCRIPTION IN DETAIL AS TO HOW CORNER WAS LOCATED AND IDENTIFIED OR RESTORED.

This corner was set from the original B.T.'s. The B. T. to the NE was fallen down but the face and scribe marks were very plain. The other B.T. was a rotted stump with face and scribe marks no longer evident. A squared post stood close to the proper location. In the proper location, I uncovered the point of the original post which had been preserved in the wet swamp. The rest of the post had completely rotted away.

SURVEYOR'S SEAL

SIGNED

Arne G. Peterson
REGISTERED LAND SURVEYOR

DATE

11/6/61