

MICHIGAN
DEPARTMENT OF CONSERVATION
FORESTRY DIVISION

LAND CORNER RECORD

T. 45 & 46 N. R. 24 W

Marquette COUNTY

DESCRIPTION OF CORNER Section Corner Common to Section 35, 36, 1 and 2

CORNER MONUMENT 2-inch iron pipe with coupling attached to end

DATE MONUMENT ~~MADE~~ AND WITNESSED April 18, 1962 by A. Metsa and W. Oliver

WITNESSES TO CORNER..... Black Spruce 6 S 48 W 35.5 links

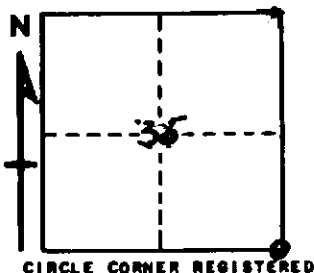

Cedar 10 N 17 W 89.0 links

W. Pine 14 N 17 E 95.0 links

AND

DESCRIPTION IN DETAIL AS TO HOW CORNER WAS LOCATED AND IDENTIFIED OR RESTORED.

This corner was set from original tamarack BT's probably by mining company surveyors apparently 40 to 50 years ago. Set new bearing trees after checking the pipe for accuracy with the original BT's. The tamarack 14 S 81 E 32 links was a 4-foot shattered stub, but had both faces plain and scribe marks very distinct on upper face. The other tamarack BT's were low, rounded stumps with all evidence of scribe marks and faces gone. All BT's, however, checked well for bearings and distances to pipe. Left pipe in exact location as found.

SURVEYOR'S SEAL

SIGNED

Arne G. Metsa
REGISTERED LAND SURVEYOR

DATE

4/20/62