

MICHIGAN  
DEPARTMENT OF CONSERVATION  
FORESTRY DIVISION

# LAND CORNER RECORD

T. 45 N. R. 26 W

Marquette COUNTY

DESCRIPTION OF CORNER Section Corner Common to Sections 23, 24, 25 and 26

CORNER MONUMENT One-inch galvanized pipe with four-inch brass cap.

DATE MONUMENT PLACED AND WITNESSED February 1, 1962 by A. Metsa

WITNESSES TO CORNER..... Cedar 7 N 75 E 37.1 links

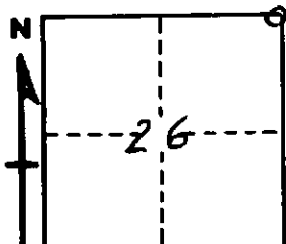

Cedar 6 S 22 W 28.4 links

Cedar 7 N 14 W 22.1 links

AND

CIRCLE CORNER REGISTERED

### DESCRIPTION IN DETAIL AS TO HOW CORNER WAS LOCATED AND IDENTIFIED OR RESTORED.

This corner was set from the two original tamarack bearing trees. The one to the south showed scribe marks very plainly; the one to the east was a badly weathered stump from which the scribe marks and face had completely disappeared. An iron pin had been set in proper location, flush with the ground, but not secured. Old square post was set near pin. Survey lines had been chopped out east and south. I set and anchored the monument in spot where pin was set, and reset pin alongside the monument. I located points of three old posts in a cluster around the pin; one of these points appeared to be the point of the original post.

SURVEYOR'S SEAL

SIGNED A. A. Metsa DATE 4/11/62  
REGISTERED LAND SURVEYOR