

MICHIGAN
DEPARTMENT OF CONSERVATION
FORESTRY DIVISION

LAND CORNER RECORD

T. 45N N.R. 27W

Marquette COUNTY

DESCRIPTION OF CORNER Sec. Cor. common to Secs. 8-9-16-17

CORNER MONUMENT 1" pipe with 4" aluminum cap.

DATE MONUMENT PLACED AND WITNESSED 10/20/66

WITNESSES TO CORNER..... 8" Jack Pine (S8 NBT) N35°W 10.1'

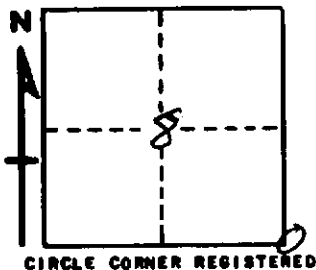

14" Jack Pine (S17 NBT) S45°W 20.6'

AND

DESCRIPTION IN DETAIL AS TO HOW CORNER WAS LOCATED AND IDENTIFIED OR RESTORED.

This corner re-established by proportionate measure from corners; 1 mile west; $\frac{1}{2}$ mile east and average distance to sec. cor. 1 mile south. Found no evidence of original cor.

SURVEYOR'S SEAL

SIGNED Billy D. Buckler DATE 1/11/67
REGISTERED LAND SURVEYOR