

MICHIGAN
DEPARTMENT OF CONSERVATION
FORESTRY DIVISION

LAND CORNER RECORD

T. 45N N.R. 27W

Marquette COUNTY

DESCRIPTION OF CORNER 1/4 cor. bet. Secs. 19-30

CORNER MONUMENT _____

DATE MONUMENT PLACED AND WITNESSED 7/21/66

WITNESSES TO CORNER..... 10" jack pine (1/8 S NBT) S 08°W 32 1/2 lks

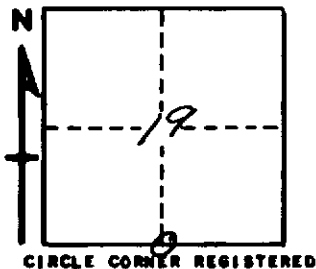

10" jack pine (1/8 S NBT) N 45°W 50 lks.

AND

DESCRIPTION IN DETAIL AS TO HOW CORNER WAS LOCATED AND IDENTIFIED OR RESTORED.

This corner replaced from two jack pine Blazs; N 38°W 34 lks and S 75°E 14 lks.

NW stump has bottom of blaze and notch remaining.

Found no evidence of use at this corner.

SURVEYOR'S SEAL

SIGNED Billy D. Buckler DATE 1/9/67
REGISTERED LAND SURVEYOR