

✓

**MICHIGAN
DEPARTMENT OF CONSERVATION
FORESTRY DIVISION**

LAND CORNER RECORD

T. 45N N.R. 27W

Marquette COUNTY

DESCRIPTION OF CORNER Sec. Cor. 22-23-26-27

CORNER MONUMENT Mon. 1" pipe with 4" aluminum cap.

DATE MONUMENT PLACED AND WITNESSED 8/11/66

WITNESSES TO CORNER..... 8" Red Oak (S22 NBT) N40°W 30.9'

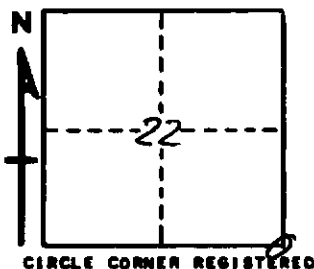

13" Red Pine (S23 NBT) East 29.1'

AND

DESCRIPTION IN DETAIL AS TO HOW CORNER WAS LOCATED AND IDENTIFIED OR RESTORED.

This corner replaced at location of old stake bottom in soil, with a red pine stub, S20°E 5 lks. Stub has old blazes, dating to the approx. period of original survey. Location checks well with other corners in area.

Corner lies 25 links east of an old railroad grade.

SURVEYOR'S SEAL

Billy D. Buckler
SIGNED Billy D. Buckler DATE 1/10/67
REGISTERED LAND SURVEYOR