

MICHIGAN
DEPARTMENT OF CONSERVATION
FORESTRY DIVISION

LAND CORNER RECORD

T. 45N R. 27W

Marquette COUNTY

DESCRIPTION OF CORNER Sec. Cor. common to Secs. 2-3-10-11

CORNER MONUMENT 1" pipe with 4" aluminum cap.

DATE MONUMENT PLACED AND WITNESSED 9/12/66

WITNESSES TO CORNER..... 9" Red Oak (S2 NBT) N34°E 51.2'

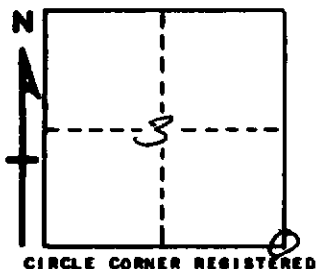

10" Red Oak (S11 NBT) S45°E 43.7'

6" Soft Maple (S10 NBT) S80°W 37.8'

AND

DESCRIPTION IN DETAIL AS TO HOW CORNER WAS LOCATED AND IDENTIFIED OR RESTORED.

This corner replaced from one probable B.T.; a w.pine bearing N41°E
13 lks. Tree down and in poor condition.

Position checks with original corners found, $\frac{1}{2}$ mile north; 1 mile
south and 1 mile west.

Corner lies on top of flat with hill sloping to south.

SURVEYOR'S SEAL

SIGNED Billy D. Buckler
Billy D. Buckler
REGISTERED LAND SURVEYOR

DATE 1/11/67