

MICHIGAN  
DEPARTMENT OF CONSERVATION  
FORESTRY DIVISION

LAND CORNER RECORD

T. 45N N.R. 27W

Marquette COUNTY

DESCRIPTION OF CORNER West 1/16 corner bet. Secs. 27-34

CORNER MONUMENT 1" pipe with 4" aluminum cap.

DATE MONUMENT PLACED AND WITNESSED 9/20/66

WITNESSES TO CORNER..... 17" Red Pine (W 1/16 24/34 BT) S18° E 35.4'

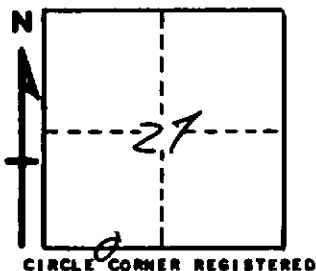

13" Jack Pine (1/16 BT) N30°W 2.1'

AND

DESCRIPTION IN DETAIL AS TO HOW CORNER WAS LOCATED AND IDENTIFIED OR RESTORED.

This corner placed midway bet. sec. cor. to west and 1/4 cor. to east.

SURVEYOR'S SEAL

SIGNED Billy D. Buckler DATE 1/11/67  
REGISTERED LAND SURVEYOR