

MICHIGAN
DEPARTMENT OF CONSERVATION
FORESTRY DIVISION

LAND CORNER RECORD

T. 45N N.R. 27W

Marquette COUNTY

DESCRIPTION OF CORNER Sec. Cor. common to Secs. 3-4-9-10

CORNER MONUMENT 1" pipe with 4" aluminum cap.

DATE MONUMENT PLACED AND WITNESSED 8/25/66

WITNESSES TO CORNER..... 10" Red Oak (S3 NBT) North 15.0'

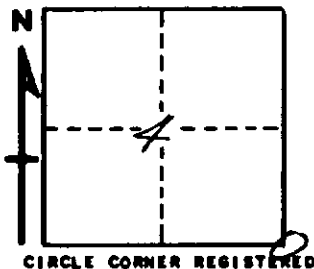

10" Red Oak (S10 NBT) S42°E 15.5'

8" Red Oak (S4 NBT) West 10.8'

AND

DESCRIPTION IN DETAIL AS TO HOW CORNER WAS LOCATED AND IDENTIFIED OR RESTORED.

This corner replaced at site of 16" W. Pine stub, a probable corner tree.
Found remains of 24" W. pine stump, bearing N55 W 05 links, a probable
bearing tree.

Position checks with other corners in area.

SURVEYOR'S SEAL

SIGNED Billy D. Buckler DATE 1/11/67
REGISTERED LAND SURVEYOR