

**LAND CORNER RECORDATION CERTIFICATE**  
**Filing Requirement of Act 74, Mich. P.A. 1970**

For corners in

Marquette

(County)

Located In:

Corner Code #

1. Public Land Survey	T <u>45N</u> R <u>29W</u>	<u>K11</u>
	T _____ R _____	_____
	T _____ R _____	_____
	T _____ R _____	_____
2. Property Controlling in Section	S <u>35</u> T <u>45N</u> R <u>29W</u>	<u>2</u>
	S _____ T _____ R _____	_____
3. Miscellaneous Property in Sec.	S _____ T _____ R _____	_____
	S _____ T _____ R _____	_____

Register of Deeds Stamp & File Number

4. Lot No. \_\_\_\_\_, Recorded Plat \_\_\_\_\_  
 5. Private Claims \_\_\_\_\_

Dec 11 2002

I, Stephan J. Szyszkoski, in a field survey on \_\_\_\_\_, 20\_\_\_\_ do hereby state that under requirements of P.A. 74, Michigan P.A. of 1970, the corner points mentioned in lines 1 and 2 above were in conformance with regulations and rules therefore as required in the current manual of survey instructions of the United States Department of the Interior, Bureau of Land Management or by a decree of a Court of Law and /or that the corner points mentioned in lines 3, 4 and 5 above were in conformance with the rules of the Michigan Board of Land Surveyors or by a Decree of a Court of Law; established, re-established, monumented, recovered, found as expressed below:

**NOTE:** Not more than 2 corners, all in the same town and range, may be recorded on this certificate.

A	B	C	D	E	F	G	H	I	J	K	L	M
1												
2	6	5		4		3		2		1		
3												
4	7	8		9		10		11		12		
5												
6	18	17		16		15		14		13		
7												
8	19	20		21		22		23		24		
9												
10	30	29		28		27		26		25		
11									•	•		
12	31	32		33		34		35		36		
13												

**A. Description of original monument and accessories and/or subsequent restoration:**  
 (K11) Corner common to Sections 25-26-35-36. 1956 --Re-monumented by Billy D. Buckler RLS: "Replaced Section Corner from remains of two White Pine stump bottoms in proper position. Traces of stake in soil..." Set 1" pipe with 4" brass cap. 10" R.Pine S38W 94 links, 8" J. Pine N12E 53 links, 13" J. Pine S37E 130 links.  
 (2-Sec. 35) East 1/16 corner between Sections 26-35. Not established in the original survey.

**B. Description of corner evidence found and/or method applied in restoring or reestablishing corner:**

(K11) Found the 1956 monument, a 1"ID iron pipe with 4" brass MI Dept. of Conservation cap, in good condition, with sq'd cedar post adjacent. The two J.Pine NBTs are no longer discernible. The R.Pine NBT was recovered at record bearing and distance. Left the monument in place and made new accessories as described below.  
 (2-Sec. 35) Established the corner midway and on a line of mean true bearing between Section corner 1318.74' East and Quarter corner 1318.74' West. The corner position falls in a 10" B.Spruce. Placed a WITNESS CORNER on the Section line, 2.00' West of the corner position.

**C. Description of monument for corner and accessories established to perpetuate locating the position of the corner:**

(K11) Found 1"ID I.pipe with 4" brass cap. 18" R.Pine with old blazes S38W 62.4' to estimated notch. Blazed, scribed, and set measuring nails in:	(2) Set 1"IDx32" I.pipe with 4" alum. MDNR cap 2.00' west of the corner and on the section line. Blazed, scribed and set measuring nails in:
4" W.Spruce N25E 8.5' "S25 NBT"	C/L 10" sq'd B.Spruce N83E 2.0" 1/16S"
12" J.Pine S30E 8.8' "S36 NBT"	8" B.Spruce S64E 26.25' "RM BT"
6" B.Spruce N08W 31.85' "S26 NBT"	10" B.Spruce S35W 22.15' do
Bearings are magnetic. Dist. to nail with tag.	9" B.Spruce N80W 11.9' do
	7" B.Spruce N15W 17.35' do
	Bearings are magnetic. Dist. to nail with tag.

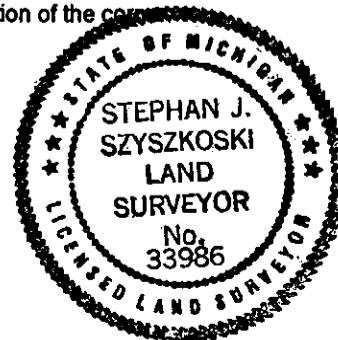

Signed by Stephan J. Szyszkoski  
 Surveyor's Michigan License No. 33986

Date 12/19/02