

LAND CORNER RECORDATION CERTIFICATE
Filing Requirement of Act 74, Mich. P.A. 1970

For corners in Marquette (County) Located In: Corner Code #
1. Public Land Survey T R
2. Property Controlling in Section S 34 T 46N R 28W 4
3. Miscellaneous Property in Sec. S T R

Register of Deeds Stamp & File Number

4. Lot No. , Recorded Plat
5. Private Claims

Jun 12 1997

I, Paul R. Bressette, in a field survey on 19 do hereby state that under requirements of P.A. 74, Michigan P.A. of 1970, the corner points mentioned in lines 1 and 2 above were in conformance with regulations and rules therefore as required in the current manual of survey instructions of the United States Department of the Interior, Bureau of Land Management or by a decree of a Court of Law and /or that the corner points mentioned in lines 3, 4 and 5 above were in conformance with the rules of the Michigan Board of Land Surveyors or by a Decree of a Court of Law; established, re-established, monumented, recovered, found as expressed below:

NOTE: Not more than 2 corners, all in the same town and range, may be recorded on this certificate.

Grid table with columns A-M and rows 1-13. Cell 11,34 contains a small black dot.

A. Description of original monument and accessories and/or subsequent restoration:

- (4) Northwest One-sixteenth corner of Section 34. Found 1" iron pipe, not of record.
(5) North One-sixteenth corner of Section 34. Not set in original survey, no evidence of subsequent establishment.

B. Description of corner evidence found and/or method applied in restoring or reestablishing corner:

- (4) Found iron pipe was rejected as corner position due to excessive distance from calculated position and no record of placement. Corner position established at the intersection of the north and east one-sixteenth lines of Section 34. Found iron pipe is SE'ly 26.9 feet from monumented position.
(5) Corner position established mid-point and on-line between the North and Center Quarter corners of Section 34.

C. Description of monument for corner and accessories established to perpetuate locating the position of the corner:

- (4) DNR monument: 04" R.Pine N27E 45.0' 1/16S,BT; 10" J.Pine S53E 41.0' 1/16S,BT; 12" J.Pine S31W 47.7' 1/16S,BT; 09" R.Pine N69W 84.8' 1/16S,BT
(5) DNR monument: 08" R.Pine N77E 56.3' (1/16S,BT); 12" R.Pine S16E 67.25' (1/16S,BT); 04" J.Pine S86W 21.2' (1/16S,BT); 09" J.Pine N46W 38.05' (1/16S,BT)
All trees are blazed, scribed and painted. Measurements are to nail in side of tree, bearings are magnetic.

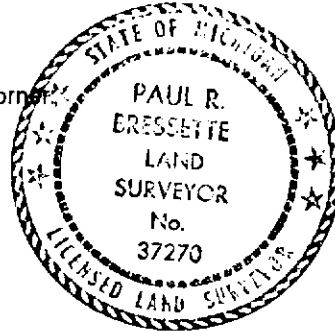

Signed by Paul R. Bressette Date
Surveyor's Michigan License No. 37270

For the Michigan Department of Natural Resources - Forest Management Division