

41

LAND CORNER RECORDATION CERTIFICATE
Filing Requirement of Act 74, Mich. P.A. 1970

For corners in Marquette (County) Located In: Corner Code #/

- 1. Public Land Survey T R
2. S 24 T 46N R 28W 1
S 24 T 46N R 28W 2
S 24 T 46N R 28W 9

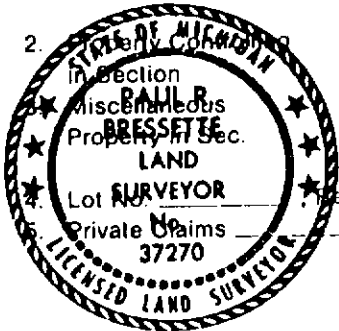

Register of Deeds Stamp & File Number

Grid table with columns A-M and rows 2-13. Contains numbers 1-36 and two dots in row 7, column L.

I, Paul R. Bressette, in a field survey on 1 January 25, 1995, do hereby certify that under requirements of P.A. 74, Michigan P.A. of 1970, the corner points mentioned in lines 1 and 2 above were in conformance with regulations and rules therefor as required in the current manual of survey instructions of the United States Department of the Interior, Bureau of Land Management or by a decree of a Court of Law and/or that the corner points mentioned in lines 3, 4 and 5 above were in conformance with the rules of the Michigan Board of Land Surveyors or by a Decree of a Court of Law, established, re-established, monumented, re-monumented, recovered, found as expressed below:

NOTE: Not more than 4 corners, all in the same town and range, may be recorded on this certificate.

A. Description of original monument and accessories and/or subsequent restoration:

- (1) West One-sixteenth corner common to Sections 13 and 24. Found iron pipe and iron pin set on an old random traverse line by unknown person, not of record.
(2) East One-sixteenth corner common to Sections 13 and 24. Not set in original survey, no evidence of subsequent establishment.
(9) East One-sixteenth corner of Section 24. Not set in original survey, no evidence of subsequent establishment.

B. Description of corner evidence found and/or method applied in restoring or reestablishing corner:

- Corner position established mid-point and on-line between the Northwest and North Quarter corners of Section 24. Iron pipe and iron pin are over 100 feet south.
(2) Corner position established mid-point and on-line between the Northeast and North Quarter corners of Section 24.
(9) Corner position established mid-point and on-line between the East and Center Quarter corners of Section 24.

C. Description of monument for corner and accessories established to perpetuate locating the position of the corner:

- (1) DNR monument: 11" J. Pine N73E 18.6', 6" J. Pine S28E 25.1', 16" J. Pine S45W 11.0', 6" J. Pine N07W 25.95'. All trees are face and butt blazed, scribed 1/16S,BT. Measurements are to notch in butt blaze. Bearings are magnetic.
(2) DNR monument: 11" J. Pine N09E 3.9', 9" J. Pine S89E 7.4', 9" J. Pine S01E 17.5', 12" J. Pine S74W 12.8'. All trees are face and butt blazed, scribed 1/16S,BT. Measurements are to notch in butt blaze. Bearings are magnetic.
(9) DNR monument: 7" J. Pine N52E 9.9', 5" J. Pine S45E 15.25', 6" J. Pine S52W 40.4', 10" J. Pine N52W 20.3'. All trees are face and butt blazed, scribed 1/16S,BT. Measurements are to notch in butt blaze. Bearings are magnetic.

Signed by Paul R. Bressette Date
Surveyor's Michigan License No. 37270