

LAND CORNER RECORDATION CERTIFICATE
Filing Requirement of Act 74, Mich. P.A. 1970

For corners in
Marquette
(County)

Located In: Corner Code =/7

- 1. Public Land Survey T 46N R 28W L8
T R
T R
T R
2. Miscellaneous Property in Sec. S 24 T 46N R 28W 14
S 24 T 46N R 28W 15
S T R
S T R

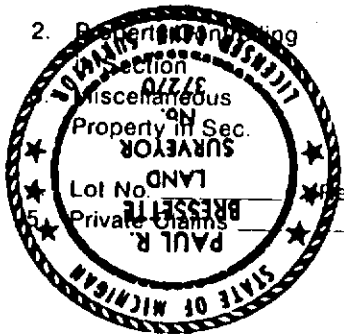

Register of Deeds Stamp & File Number

Recorded Plat

15 January 24, 1995
14 January 30, 1995

I, Paul R. Brassette, in a field survey on L8 February 01, 1995, do hereby certify that under requirements of P.A. 74, Michigan P.A. of 1970, the corner points mentioned in lines 1 and 2 above were in conformance with regulations and rules therefore as required in the current manual of survey instructions of the United States Department of the Interior, Bureau of Land Management or by a decree of a Court of Law and/or that the corner points mentioned in lines 3, 4 and 5 above were in conformance with the rules of the Michigan Board of Land Surveyors or by a Decree of a Court of Law; established, re-established, monumented, re-monumented, recovered, found as expressed below:

NOTE: Not more than 4 corners, all in the same town and range, may be recorded on this certificate.

Grid table with columns A-M and rows 2-13. Contains numbers 1-36 and symbols representing corner locations.

A. Description of original monument and accessories and/or subsequent restoration:

- (L8) Center Quarter corner of Section 24. Not set in original survey, no evidence of subsequent establishment.
(14) South One-sixteenth corner common to Sections 24 and 19. Found 3/4" iron pin set by unknown person and not of record.
(15) West One-sixteenth corner common to Sections 24 and 25. Found iron pipe set by unknown person and not of record.

B. Description of corner evidence found and/or method applied in restoring or reestablishing corner:

- (L8) Corner position established at the intersection of the North-South and East-West quarter lines of Section 24.
(14) Rejected iron pin since it falls S36W 10.30' from calculated position. Corner position established mid-point and on-line between the Southeast and East Quarter corners of Section 24.
(15) Rejected iron pipe since it falls S72W 35.07' from calculated position. Corner position established mid-point and on-line between the Southwest and South Quarter corners of Section 24.

C. Description of monument for corner and accessories established to perpetuate locating the position of the corner:

- (L8) DNR monument: 10" J. Pine N37E 14.75', 8" J. Pine S26E 17.15', 7" J. Pine S37W 14.45', 9" J. Pine N25W 16.0'. All trees are face and butt blazed, scribed 1/4S,BT. Measurements are to notch in butt blaze. Bearings are magnetic.
(14) DNR monument: P. Pole N32E 70.5', 7" J. Pine S58E 59.15', 6" J. Pine N81W 22.45', 6" J. Pine N04W 49.6'. All trees are face and butt blazed, scribed 1/16S,BT. Measurements are to notch in butt blaze, except p. pole which has a PK w/DNR reference tag. Bearings are magnetic.
(15) DNR monument: 5" J. Pine N80E 17.4', 6" J. Pine S29E 58.6', 6" J. Pine S47W 14.8', 8" J. Pine N32W 43.1'. All trees are face and butt blazed, scribed 1/16S,BT. Measurements are to notch in butt blaze. Bearings are magnetic.

Signed by Paul R. Brassette

Date

Surveyor's Michigan License No. 37270