

MICHIGAN  
DEPARTMENT OF CONSERVATION  
FORESTRY DIVISION

# LAND CORNER RECORD

T. 46 N.R. 29W

Marquette COUNTY

DESCRIPTION OF CORNER Sec. Cor. common to secs. 25-26-35-36

CORNER MONUMENT 1" pipe with 4" aluminum cap.

DATE MONUMENT PLACED AND WITNESSED 10/13/66

WITNESSES TO CORNER..... 12" Red Pine (S26 NBT) N55°W, 35.2'

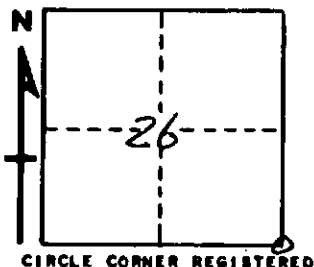

10" Red Pine (S35 NBT) S42°W, 16.7'

10" Red Pine (S25 NBT) N74°E, 28.6'

AND

DESCRIPTION IN DETAIL AS TO HOW CORNER WAS LOCATED AND IDENTIFIED OR RESTORED.

This corner replaced 1.80 chains north of a large boulder as indication in original notes. Found remains of jack pine stump bearing N60°W, 83 links for one possible bearing tree.

Found squared jack pine 6 links, north of sec. cor. monument.

Position checks with other corners in area.

Placed location poster 10 chains north on road.

SURVEYOR'S SEAL

SIGNED *Billy D. Buckler* DATE 2/8/67  
REGISTERED LAND SURVEYOR