

LAND CORNER RECORDATION CERTIFICATE
Filing Requirement of Act 74, Mich. P.A. 1970

For corners in

Marquette

(County)

Located In:

Corner Code #

- | | | |
|------------------------------------|---------------------------|------------|
| 1. Public Land Survey | T <u>46N</u> R <u>29W</u> | <u>J11</u> |
| | T <u>46N</u> R <u>29W</u> | <u>J12</u> |
| 2. Property Controlling in Section | S ___ T ___ R ___ | ___ |
| | S ___ T ___ R ___ | ___ |
| | S ___ T ___ R ___ | ___ |
| 3. Miscellaneous Property in Sec. | S ___ T ___ R ___ | ___ |
| | S ___ T ___ R ___ | ___ |

Register of Deeds Stamp & File Number

4. Lot No. _____, Recorded Plat _____
 5. Private Claims _____

Aug 26 2003

I, Stephan J. Szyszkoski, in a field survey on _____, 20___ do hereby state that under requirements of P.A. 74, Michigan P.A. of 1970, the corner points mentioned in lines 1 and 2 above were in conformance with regulations and rules therefore as required in the current manual of survey instructions of the United States Department of the Interior, Bureau of Land Management or by a decree of a Court of Law and /or that the corner points mentioned in lines 3, 4 and 5 above were in conformance with the rules of the Michigan Board of Land Surveyors or by a Decree of a Court of Law; established, re-established, monumented, recovered, found as expressed below:

NOTE: Not more than 2 corners, all in the same town and range, may be recorded on this certificate.

A	B	C	D	E	F	G	H	I	J	K	L	M
1												
2	6		5		4		3		2		1	
3												
4	7		8		9		10		11		12	
5												
6	18		17		16		15		14		13	
7												
8	19		20		21		22		23		24	
9												
10	30		29		28		27		26		25	
11									●			
12	31		32		33		34		●		36	
13												

A. Description of original monument and accessories and/or subsequent restoration:

- (J11) Quarter corner common to Sections 26-35. 1848: Established by Harvey Mellen. West corrected between 26 & 35...40.08 Set spruce pine post qr. section corner. Spruce Pine 10 N22E 8 dead, Spruce Pine 10 S13E 10. ...80.16 Section corner.
 (J12) Center of Section 35. Not established in the original survey.

B. Description of corner evidence found and/or method applied in restoring or reestablishing corner:

- (J11) The original post and accessories were not recovered. Reestablished the corner midway and on a line of mean true bearing between Section corners 2650.30' east and west.
 (J12) Established the corner at the intersection of straight lines connecting opposite 1/4 corners.

C. Description of monument for corner and accessories established to perpetuate locating the position of the corner:

- | | |
|---|--|
| (J11) Set 1"IDx32" I.pipe with 4" alum. MDNR cap. Blazed, scribed, and set measuring nails in:
7" J.Pine S77E 38.4' "1/4S NBT"
9" J.Pine S11W 30.4' do
2" Maple N54W 15.2' do
11" J.Pine N04W 38.8' do
Set cedar post adjacent. Bearings are magnetic. Distances are to nail with tag. | (J12) Set 1"IDx32" I.pipe with 4" alum. MDNR cap. Blazed, scribed, and set measuring nails in:
8" J. Pine N15E 3.0' "C1/4 8T"
15" J.Pine S16E 14.1' do
6" R.Pine S50W 33.3' do
8" R.Pine N68W 4.9' do
Set squared cedar post adjacent. Bearings are magnetic. Distances are to nail with tag. |
|---|--|

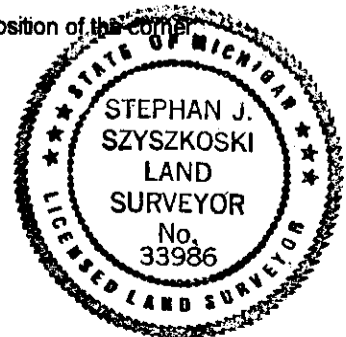

Signed by Stephan J. Szyszkoski
 Surveyor's Michigan License No. 33986

Date 9/3/03