

SURVEY & MONUMENTATION

MAY 22 1997

LAND CORNER RECORDATION CERTIFICATE
Filing Requirement of Act 74, Mich. P.A. 1970

For corners in
COMMISSION
MARQUETTE
(County)

Located In:	Corner Code #
T 48NR 30W	I-13
T 47NR 30W	J-1
T R	
T R	
S T R	
S T R	
S T R	
S T R	

RECORDED Dec 30 1996
AT 4:20 O'CLOCK P.M.
LIBER OF PAGE
Sabrina D. Montey
REGISTER OF DEEDS

- 1. Public Land Survey
- 2. Property Controlling in Section
- 3. Miscellaneous Property in Sec.

LIBER **1** PAGE **382**
Register of Deeds Stamp & File Number

4. Lot No. _____, Recorded Plat _____
5. Private Claims _____

I, ALAN K. PIERCE, in a field survey on NOVEMBER 19 96 do hereby state that under requirements of P.A. 74, Michigan P.A. of 1970, the corner points mentioned in lines 1 and 2 above were in conformance with regulations and rules therefore as required in the current manual of survey instructions of the United States Department of the Interior, Bureau of Land Management or by a decree of a Court of Law and/or that the corner points mentioned in lines 3, 4 and 5 above were in conformance with the rules of the Michigan Board of Land Surveyors or by a Decree of a Court of Law; established, re-established, monumented, recovered, found as expressed below:

NOTE: Not more than 2 corners, all in the same town and range, may be recorded on this certificate.

	A	B	C	D	E	F	G	H	I	J	K	L	M
1													
2	6		5		4		3		2		1		
3													
4	7		8		9		10		11		12		
5													
6	10		17		16		15		14		13		
7													
8	19		20		21		22		23		24		
9													
10	30		29		28		27		26		25		
11													
12	31		32		33		34		35		36		
13													

A. Description of original monument and accessories and/or subsequent restoration:
Quarter Corner common to Sections 2 and 35, T47/48N - R30W

I-13: 1846; W. A. John and Austin Burt D. S. set a Maple post witnessed by: 10' Spruce N62°E 36L; 10' Spruce N60°W 14L. 1904; Under special instructions from the G.L.O. Commissioner dated March 17, 1904 and prior to starting a "Survey of fifteen (15) islands in Lake Michigamme", Arthur Kidder D. S. found a 4" X 4" Cedar post 5' above grade. No witnesses noted. 1962; R.L.S. No. 7876 set a galvanized iron pipe with aluminum cap stamped to identify the corner equidistant on line between I-13 and K-13 witnessed by scribed: 8" Maple S33°W 60L; 14" Maple N71°E 31L. Recorded in L2R.C., Pg. 348. 1983; R.L.S. No. 25836 recovered capped pipe per L1 S.M. Pg. 498, 499 and 501 and noted witnesses by P.K. nails in: 4" Maple N40°E 9.95'; 18" Maple N75°E 19.72'; 6" Twin Maple S20°W 17.04'; 10" Twin Basswood N55°W 13.69'.

B. Description of corner evidence found and/or method applied in restoring or reestablishing corner:

J-13: 1996; ECI recovered capped galvanized pipe. No original corner evidence recovered. The following measurements were taken to Kidder Island Survey (K.G.L.O.), terrain calls: East "gradual descent" ECI 1092' - K.G.L.O. 1062'; West "commence gradual ascent" ECI 796' - K.G.L.O. 786', "top of slope" ECI 1358' - K.G.L.O. 1314', "base of slope" ECI 1766' - K.G.L.O. 1643' (prior 2 calls intersect town line at oblique angle), "top high stony ridge" ECI 2304' - K.G.L.O. 2304'. Corner position established by acceptance of capped galvanized pipe as a careful and faithful reestablishment of the position of the original corner. Distance East is 2646.34' and distance West is 2641.95'.

C. Description of monument for corner and accessories established to perpetuate locating the position of the corner:

1996: Stamped "MCR-1996" on the aluminum cap. Bearing trees are face, nail & butt blazed and painted yellow with B.T. tags attached. Butt blaze is scribed "B.T.". Three 1983 trees were utilized with distances measured from a duplex nail with an orange washer stamped "ECI-30097" in the side of the tree. Bearings are magnetic.

6" Maple N44°E 10.04'; 7" Maple S35°E 30.50' (N.B.T.); 8" Twin Maple S20°W 16.93'; 10" Ash (near trees, Twin Basswood) N54°W 13.36'

RATIFIED BY PEER GROUP
P.A. 345 OF 1990
Larry J. Benson
DATE 11/4/96

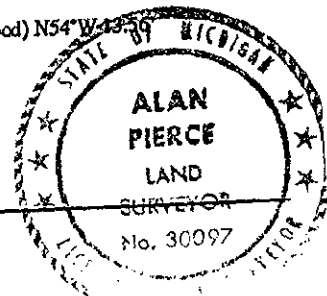

Signed by Alan K. Pierce
Surveyor's Michigan License No. 30097

Date 12-19-96