

LAND CORNER RECORDATION CERTIFICATE
Filing Requirement of Act 74, Mich. P.A. 1970

For corners in
Marquette

(County)

Located In: Corner Code #

1. Public Land Survey	T <u>52N</u> R <u>29W</u>	<u>C7</u>
	T _____ R _____	_____
	T _____ R _____	_____
	T _____ R _____	_____
2. Property Controlling in Section	S _____ T _____ R _____	_____
	S _____ T _____ R _____	_____
3. Miscellaneous Property in Sec.	S _____ T _____ R _____	_____
	S _____ T _____ R _____	_____

Register of Deeds Stamp & File Number

4. Lot No. _____, Recorded Plat _____
 5. Private Claims _____

Jun 04 2002

I, Stephan J. Szyszkoski, in a field survey on _____, 20____ do hereby state that under requirements of P.A. 74, Michigan P.A. of 1970, the corner points mentioned in lines 1 and 2 above were in conformance with regulations and rules therefore as required in the current manual of survey instructions of the United States Department of the Interior, Bureau of Land Management or by a decree of a Court of Law and /or that the corner points mentioned in lines 3, 4 and 5 above were in conformance with the rules of the Michigan Board of Land Surveyors or by a Decree of a Court of Law, established, re-established, monumented, recovered, found as expressed below:

NOTE: Not more than 2 corners, all in the same town and range, may be recorded on this certificate.

	A	B	C	D	E	F	G	H	I	J	K	L	M
1													
2	6		5		4		3		2		1		
3													
4	7		8		9		10		11		12		
5													
6	18		17		16		15		14		13		
7			●										
8	19		20		21		22		23		24		
9													
10	30		29		28		27		26		25		
11													
12	31		32		33		34		35		36		
13													

A. Description of original monument and accessories and/or subsequent restoration:

(C7) Corner common to Sections 17-18-19-20. 1846: Established by Hubbard and Ives. North between Section 19 & 20...80.00 Set post corner of 17-18-19-20. Hemlock 24 S69E 31, Y.Birch 9 N63W 33. 1950: Notes of N.T.Thompson, RLS, state: "9/6/50 There is old wire fence here so set ced. post where they had cor of fence. This checks very good from south."

B. Description of corner evidence found and/or method applied in restoring or reestablishing corner:

(C7) The original post and accessories were not recovered. Found a 1" ID iron pipe projecting 1.2 ft. in the remains of an old N-S fence. An old blaze line runs north from this position. Distance south to an original corner is 79.893 ch, which checks well against the original 80.00 ch. Distance east to monumented section corner is 80.237 ch, which checks well against 80.28 ch. original. Found 1/4 cor. east monumented at proportionate position using this C7 monument. Accept the pipe as the best available evidence of the position of the original corner, left it in place, and made witnesses as described below.

C. Description of monument for corner and accessories established to perpetuate locating the position of the corner:

(C7) Found 1" ID iron pipe projecting 1.2 ft. a.g. Blazed and scribed:
 12" Sugar N51E 13.3' "S17 NBT"
 18" Hemlock S53E 42.6' "S20 NBT"
 4" Y.Birch S13E 17.2' "S20 NBT"
 7" Y.Birch S76W 4.5' "S19 NBT"
 Placed squared sugar post adjacent.
 Bearings are magnetic. Distances to notch in lower blaze.

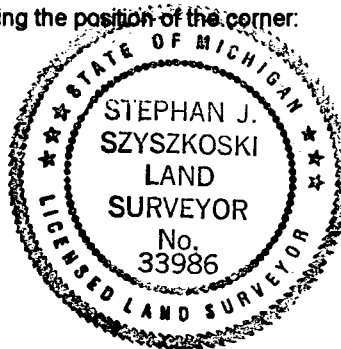

Signed by Stephan J. Szyszkoski
 Surveyor's Michigan License No. 33986

Date 6/12/02