

SURVEY & REMONUMENTATION

JAN 09 2001

SECTION

LAND CORNER RECORDATION CERTIFICATE Filing Requirement of Act 74, Mich. P.A. 1970

Approved by Menominee County
Land Survey Remonumentation
Peer Group Under Act 345 of
P.A. of 1990 On 12/22, 2000
Mc Davis RLS
Chairman

BR. 6 Pg. 214

For corners in

MENOMINEE

(County)

Located In:

Corner Code #

- | | | | | |
|------------------------------------|---------------------------|-------|-------|-------|
| 1. Public Land Survey | T <u>33N</u> R <u>26W</u> | D-13 | | |
| | T _____ R _____ | _____ | _____ | _____ |
| | T _____ R _____ | _____ | _____ | _____ |
| | T _____ R _____ | _____ | _____ | _____ |
| 2. Property Controlling in Section | S _____ T _____ R _____ | _____ | _____ | _____ |
| | S _____ T _____ R _____ | _____ | _____ | _____ |
| 3. Miscellaneous Property in Sec. | S _____ T _____ R _____ | _____ | _____ | _____ |
| | S _____ T _____ R _____ | _____ | _____ | _____ |

RECEIVED FOR RECORD
28 DEC 2000 2:31:31 PM
BARBARA MORRISON
REGISTER OF DEEDS
MENOMINEE, MI 49858

Register of Deeds Stamp & File Number

4. Lot No. _____, Recorded Plat _____

5. Private Claims _____

SAME AS CORNER D-1, T32N-R26W ✓

	A	B	C	D	E	F	G	H	I	J	K	L	M
1													
2	6		5		4		3		2		1		
3													
4	7		8		9		10		11		12		
5													
6	18		17		16		15		14		13		
7													
8	19		20		21		22		23		24		
9													
10	30		29		28		27		26		25		
11													
12	31		32		33		34		35		36		
13													

I, William Lenca, in a field survey on Oct, 1900 do hereby state that under requirements of P.A. 74, Michigan P.A. of 1970, the corner points mentioned in lines 1 and 2 above were in conformance with regulations and rules therefore as required in the current manual of survey instructions of the United States Department of the Interior, Bureau of Land Management or by a decree of a Court of Law and/or that the corner points mentioned in lines 3, 4 and 5 above were in conformance with the rules of the Michigan Board of Land Surveyors or by a Decree of a Court of Law; established, re-established, monumented, recovered, found as expressed below:

NOTE: Not more than 2 corners, all in the same town and range, may be recorded on this certificate.

A. Description of original monument and accessories and/or subsequent restoration:

- 1847: Original Survey by James H. Mullett - B.T.'s - Y. Birch, 18" - N40°W - 27 lks.; Cedar, 10" - N10°E - 54 lks.; All original evidence or this corner has been destroyed by County Road improvements.
- 1960: Plat of Survey by Robert Olsen, RLS 10700, shows Corner with tie to R/W Monuments E. side of Hwy M-35
- 1962: Plat of Survey by Robert Olsen, RLS 10700, shows tie to W. R/W of Hwy M-35 and to Lot Corners South along Highway.
- 1983: Plat of Survey by William Lenca, RLS No. 26461, states a 3/4" dia. Iron Pin was found. Also shows distance to 1/16 Corner and Section Corner West.

B. Description of corner evidence found and/or method applied in restoring or reestablishing corner:

We found a 3/4 inch diameter Iron Pin 21 feet North of the centerline of an East - West County Road and in line with an ancient fence line running North, as indicated in Robert Olsen's Surveys noted in part A. Measurements from this iron pin to a concrete right-of-way monument on the East side of Highway M-35 and to lot corners on the West side of Highway M-35 fit with Robert Olsen's record measurement as shown in his Plat of Surveys from 1960 and 1962 as noted in part A. The distance from this corner to the Section Corner 1/2 mile West is 2636.96 feet. This corner has been accepted and used by local surveyors for at least 40 years, and is accepted as the best available evidence of the position of the original corner.

C. Description of monument for corner and accessories established to perpetuate locating the position of the corner:

Set 2" dia. Aluminum Pipe 30" long/3-1/4" dia. Alum cap stamped for corner location:

7" dia. White Ash	N65°E	32.69 feet	Scr. NBT	
20" dia. White Pine	S20°E	87.13 feet	Scr. NBT	
14" dia. Cedar	S30°W	75.33 feet	Scr. NBT	
7" dia. White Ash	N65°W	35.47 feet	Scr. NBT	
Metal Survey Sign Post	South	52.95 feet		

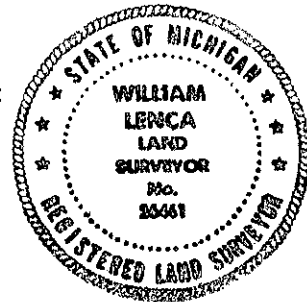

NOTE: All bearings are magnetic bearings. All distances are measured with steel tape. Distances to trees are to nail in side of tree.

Signed by William Lenca
Surveyor's Michigan License No. 26461

Date Dec. 21, 2000