

1893

COGNITION

LAND CORNER RECORDATION CERTIFICATE
Filing Requirement of Act 74, Mich. P.A. 1970

Approved by Menominee County
Land Survey Remonumentation
Peer Group Under Act 345 Of
P.A. Of 1990 On 12/03, 199 93
Mike Adams
Chairman

For corners in

<u>MENOMINEE</u> (County)	Located In:	Corner Code #:
1. Public Land Survey	T <u>32N</u> R <u>27W</u>	<u>C-3</u>
	T _____ R _____	_____
	T _____ R _____	_____
	T _____ R _____	_____
2. Property Controlling in Section	S _____ T _____ R _____	_____
	S _____ T _____ R _____	_____
3. Miscellaneous Property in Sec.	S _____ T _____ R _____	_____
	S _____ T _____ R _____	_____
4. Lot No. _____, Recorded Plat _____		
5. Private Claims _____		

RECEIVED FOR RECORD
93 DEC 29 PM 3:53
PAGE # 18
BARBARA MORRISON
REGISTER OF DEEDS
MENOMINEE MI 49858
Register of Deeds Stamp & File Number

I, William Lenca, in a field survey on October, 19 93, do hereby certify that under requirements of P.A. 74, Michigan P.A. of 1970, the corner points mentioned in lines 1 and 2 above were in conformance with regulations and rules therefore as required in the current manual of survey instructions of the United States Department of the Interior, Bureau of Land Management or by a decree of a Court of Law and/or that the corner points mentioned in lines 3, 4 and 5 above were in conformance with the rules of the Michigan Board of Land Surveyors or by a Decree of a Court of Law; established, re-established, monumented, re-monumented, recovered, found as expressed below:

A	B	C	D	E	F	G	H	I	J	K	L	M
2	6	5	4	3	2	1						
3	7	8	9	10	11	12						
4												
5												
6	18	17	16	15	14	13						
7												
8	19	20	21	22	23	24						
9												
10	30	29	28	27	26	25						
11												
12	31	32	33	34	35	36						
13												

NOTE: Not more than 4 corners, all in the same town and range, may be recorded on this certificate.

A. Description of original monument and accessories and/or subsequent restoration:

ORIGINAL B.T.'s: Hemlock, 24", S40°E, 07 lks
Maple, 16" N51°W, 30 lks

Original Survey by James H. Mullett in 1848. All original evidence for this corner has been destroyed by county road improvements.

PERPETUATION: William Lenca in April, 1989 - recorded in LCRC No. 847, Book 3.

B. Description of corner evidence found and/or method applied in restoring or reestablishing corner:

In a 1989 survey of this area, I found a 1/2" diameter Iron Rod set by George B. Wilson, RLS 17607, as shown and recorded in Certified Survey No. 204. The corner position falls in the centerline of the intersection of county roads North - South and East-West. This corner has been used for control in several surveys in the area, and is accepted as the best available evidence of the position of the original corner.

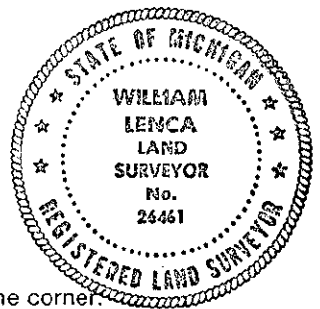

C. Description of monument for corner and accessories established to perpetuate locating the position of the corner:

Set 5/8" x 24" Iron Rod/3 1/4" dia. Alum. cap stamped for corner:

5/8" x 24" Iron Rod/2" dia. Alum. cap (WITNESS MARKER)	N45°E	58.10 feet
" " " " " "	S45°E	49.67 feet
" " " " " "	S45°W	57.67 feet
" " " " " "	N45°W	55.78 feet

NOTE: All bearings are magnetic bearings; distances are measured with steel tape.

Signed by William Lenca Date December 7, 1993
Surveyor's Michigan License No. 26461