

1993

COMMISSION

LAND CORNER RECORDATION CERTIFICATE
Filing Requirement of Act 74, Mich. P.A. 1970

Approved by Menominee County
Land Survey Remonumentation
Peer Group Under Act 345 Of
P.A. Of 1990 On 12/29 1993
Met Havelis
Chairman

For corners in

Table with columns: MENOMINEE (County), Located In: (Town/Range), Corner Code #. Includes entries for Public Land Survey, Property Controlling in Section, Miscellaneous Property in Sec., Lot No., and Private Claims.

RECEIVED FOR RECORD
93 DEC 29 PM 3:53
PAGE #23
BARBARA MORRISON
REGISTER OF DEEDS
MENOMINEE, MI 49853

Register of Deeds Stamp & File Number

I, William Lenca, in a field survey on September, 1993, do hereby certify that under requirements of P.A. 74, Michigan P.A. of 1970, the corner points mentioned in lines 1 and 2 above were in conformance with regulations and rules therefore as required in the current manual of survey instructions of the United States Department of the Interior, Bureau of Land Management or by a decree of a Court of Law and/or that the corner points mentioned in lines 3, 4 and 5 above were in conformance with the rules of the Michigan Board of Land Surveyors or by a Decree of a Court of Law; established, re-established, monumented, re-monumented, recovered, found as expressed below:

Grid table with columns A-M and rows 2-13. A dot is marked at the intersection of column B and row 4.

NOTE: Not more than 4 corners, all in the same town and range, may be recorded on this certificate.

A. Description of original monument and accessories and/or subsequent restoration:

ORIGINAL B.T.'s: Birch, 14", N10°W, 21 lks
Birch, 10", N80°E, 12 lks

Original Survey by James H. Mullett in 1848. All original evidence for this corner has been destroyed by farming activities and county road improvements.

PERPETUATION: George B. Wilson (RLS 17607) in Jan. 1981 - Certified Survey No. 204 shows a subdivision of Section 8, T32N-R27W, indicating the location of Corner C-4. LCRC No. 722, Book 3 recorded by William Lenca, RLS No. 26461, based on information in Certified Survey No. 204.

B. Description of corner evidence found and/or method applied in restoring or reestablishing corner:

Found 5/8" dia. Iron Rod/identification cap (MI 26461/WI11569) in location matching information contained in Certified Survey No. 204. There is about an 8° deflection in the county road at this location, and the corner falls at the PI of the centerlines running North and South from this position. There is also an old lane running East and an old fence line running West from this location. This corner has been used for control in surveys in this area, and is accepted as the best available evidence of the location of the original corner.

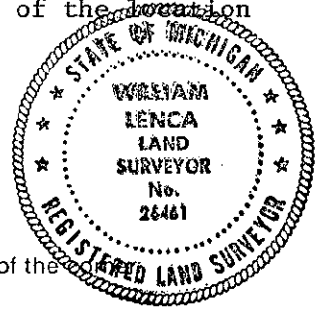

C. Description of monument for corner and accessories established to perpetuate locating the position of the

Set 5/8" x 24" Iron Rod/3 1/4" dia. Aluminum cap stamped for corner:

Table with 3 columns: Monument description, Bearing, Distance. Includes entries for 5/8" x 24" Iron Rod/2" dia. Alum. cap marked WITNESS MARKER with bearings N52°E, S35°E, S60°W, N30°W and distances 29.05 feet, 31.38 feet, 36.70 feet, 53.65 feet.

NOTE: All bearings are magnetic bearings; distances are measured with steel tape. distances to trees are measured to nail in side of tree.

Signed by William Lenca Date December 10, 1993
Surveyor's Michigan License No. 26461