

1993

COMMISSION

LAND CORNER RECORDATION CERTIFICATE
Filing Requirement of Act 74, Mich. P.A. 1970

Approved by Menominee County
Land Survey Remonumentation
Peer Group Under Act 345 Of
P.A. Of 1990 On 12/29 19993
MEL DAVIS
Chairman

For corners in

<u>MENOMINEE</u> <small>(County)</small>	Located In:	Corner Code #
1. Public Land Survey	T <u>32N</u> R <u>27W</u>	<u>C-7</u>
	T _____ R _____	_____
	T _____ R _____	_____
	T _____ R _____	_____
2. Property Controlling in Section	S _____ T _____ R _____	_____
	S _____ T _____ R _____	_____
3. Miscellaneous Property in Sec.	S _____ T _____ R _____	_____
	S _____ T _____ R _____	_____

RECEIVED FOR RECORD
93 DEC 29 PM 3:50
PAGE # 5-124
BARBARA MORRISON
REGISTER OF DEEDS
MENOMINEE, MI 49858

Register of Deeds Stamp & File Number

- 4. Lot No. _____, Recorded Plat _____
- 5. Private Claims _____

	A	B	C	D	E	F	G	H	I	J	K	L	M
2	6		5		4		3		2		1		
3													
4	7		8		9		10		11		12		
5													
6	18		17		16		15		14		13		
7													
8	19		20		21		22		23		24		
9													
10	30		29		28		27		26		25		
11													
12	31		32		33		34		35		36		
13													

I, William Lenca, in a field survey on September, 1993
do hereby certify that under requirements of P.A. 74, Michigan P.A. of 1970, the corner points mentioned
in lines 1 and 2 above were in conformance with regulations and rules therefore as required in the
current manual of survey instructions of the United States Department of the Interior, Bureau of Land
Management or by a decree of a Court of Law and/or that the corner points mentioned in lines 3, 4 and 5
above were in conformance with the rules of the Michigan Board of Land Surveyors or by a Decree of a
Court of Law; established, re-established, monumented, re-monumented, recovered, found as
expressed below:

NOTE: Not more than 4 corners, all in the same town and range, may be recorded
on this certificate.

A. Description of original monument and accessories and/or subsequent restoration:

ORIGINAL B.T.'s: Yellow Pine, 16", N67°E, 17 lks
Birch, 8", S7½°E, 19 lks

Original Survey by James H. Mullett in 1848. No original evidence found.

PERPETUATION: Albert Haas, County Surveyor, in a 1900 survey states "Set 4" Cedar Post
from Government B.T.". This survey is on record in "County Surveyor's Record" Book
on page 16, Menominee County Records.

B. Description of corner evidence found and/or method applied in restoring or reestablishing corner:

In a retracement of Albert Haas survey of 1900 (mentioned in A above), along the West Line
of Section 17, T32N-R27W, we found a very old fence (circa early 1900's) at the South 1/16
line. The distance from the Northeast Corner of Section 17, measured south along an old
North - South fence to this old 1/16 fence, matches Haas' recorded distance. Corner C-7
was set on the extension of the old North-South fence and at Haas' recorded distance, and
is accepted as a careful and faithful perpetuation of the position of the original corner.

C. Description of monument for corner and accessories established to perpetuate locating the position of the corner:

Existing 5/8" dia. Alum. Rod 5' long/3¼" dia. Alum. cap stamped for corner:

8" dia. White Birch	N02°W	60.92 feet
9" dia. Maple	N78°E	19.91 feet
16" dia. Maple	S10°E	17.04 feet
8" dia. Spruce	S68°W	28.05 feet
Metal Survey Sign Post	S68°W	1.6 feet

NOTE: All bearings are magnetic bearings; distances are measured with steel tape.
distances to trees are measured to nail in side of tree.

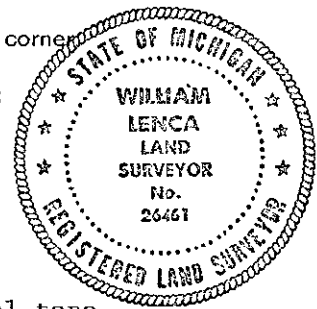

Signed by William Lenca Date December 13, 1993
Surveyor's Michigan License No. 26461