

1993

COMMISSION

LAND CORNER RECORDATION CERTIFICATE
Filing Requirement of Act 74, Mich. P.A. 1970

Approved by Menominee County Land Survey Remonumentation Peer Group Under Act 345 Of P.A. Of 1990 On 12/28 1992
Mc Davis Chairman

For corners in

Form with fields for County (MENOMINEE), Located In, Corner Code (#), and numbered items 1-5 for survey details.

RECEIVED FOR RECORD
93 DEC 29 PM 3:50
PAGE # 7
BARBARA MORRISON
REGISTER OF DEEDS
MENOMINEE, MI 49858

Register of Deeds Stamp & File Number

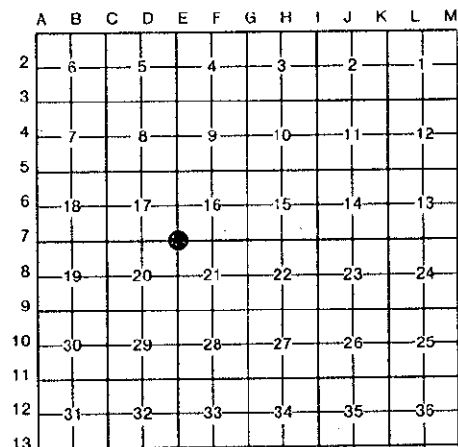

I, William Lenca, in a field survey on September, 19 93, do hereby certify that under requirements of P.A. 74, Michigan P.A. of 1970, the corner points mentioned in lines 1 and 2 above were in conformance with regulations and rules therefore as required in the current manual of survey instructions of the United States Department of the Interior, Bureau of Land Management or by a decree of a Court of Law and/or that the corner points mentioned in lines 3, 4 and 5 above were in conformance with the rules of the Michigan Board of Land Surveyors or by a Decree of a Court of Law; established, re-established, monumented, re-monumented, recovered, found as expressed below:

NOTE: Not more than 4 corners, all in the same town and range, may be recorded on this certificate.

A. Description of original monument and accessories and/or subsequent restoration:

ORIGINAL B.T.'s: Hemlock, 14", N45°W, 22 lks
Aspen, 18", N61°E, 13 lks

Original Survey by James H. Mullett in 1848. All original evidence for this corner has been destroyed by farming activities.

PERPETUATION: George B. Wilson in March, 1982 - LCRC No. 380, Book 2 of Corner Records. Certified Survey No. 269 by George B. Wilson (RLS No. 17607) shows the location of this corner as it relates to other corners in Section 16.

B. Description of corner evidence found and/or method applied in restoring or reestablishing corner:

Found 5/8" dia. Iron Rod at old fence corner running North and East from this location. I placed this iron in November of 1988 by retracement of the West Line of Section 16, T32N-R27W, as shown in Certified Survey No. 269. There is no evidence of the "HDR" Monument noted by George B. Wilson in LCRC No. 380 mentioned above. This position fits well with existing fences and matches the dimensions shown in Certified Survey No. 269, and is accepted as the best available evidence of the position of the original corner.

C. Description of monument for corner and accessories established to perpetuate locating the position of the corner:

Set 5/8" x 24" Iron Rod/3/4" dia. Alum. cap stamped for corner:

Table with 3 columns: Monument Description, Bearing, and Distance. Includes items like 5/8" x 24" Iron Rod/2" dia. cap (WITNESS MARKER) and Metal Survey Sign Post.

NOTE: All bearings are magnetic bearings; distances are measured with steel tape.

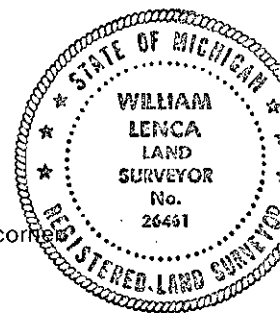

Signed by William Lenca Date December 13, 1993
Surveyor's Michigan License No. 26461