

SURVEY & REMONUMENTATION

LAND CORNER RECORDATION CERTIFICATE

Filing Requirement of Act 74, Mich. P.A. 1970

Approved by Menominee County
Land Survey Remonumentation
Peer Group Under Act 246 Of

P.A. of 1993 On DEC 16 1994
Mr. Davis RLS
ALTING

For corners in
MENOMINEE
(County)

APR 11 1995
LOCAL SURVEYOR
COMMISSION

	Local Section	Corner Code #
1. Public Land Survey	T <u>32NR</u> <u>27W</u>	<u>E-08</u>
	T _____ R _____	_____
	T _____ R _____	_____
	T _____ R _____	_____
2. Property Controlling in Section	S _____ T _____ R _____	_____
	S _____ T _____ R _____	_____
3. Miscellaneous Property in Sec.	S _____ T _____ R _____	_____
	S _____ T _____ R _____	_____

RECEIVED FOR RECORD
94 DEC 27 AM 10:4
PAGE # 199 BK. 4
BARBARA MORRISON
REGISTER OF DEEDS
MENOMINEE, MI 49858
Register of Deeds Stamp & File Number

4. Lot No. _____, Recorded Plat _____
5. Private Claims _____

William Lenca Dec. 06 94

I, _____, in a field survey on _____, 19 _____, do hereby certify that under requirements of P.A. 74, Michigan P.A. of 1970, the corner points mentioned in lines 1 and 2 above were in conformance with regulations and rules therefore as required in the current manual of survey instructions of the United States Department of the Interior, Bureau of Land Management or by a decree of a Court of Law and/or that the corner points mentioned in lines 3, 4 and 5 above were in conformance with the rules of the Michigan Board of Land Surveyors or by a Decree of a Court of Law; established, re-established, monumented, re-monumented, recovered, found as expressed below:

	A	B	C	D	E	F	G	H	I	J	K	L	M
2	6	5	4	3	2	1							
3													
4	7	8	9	10	11	12							
5													
6	13	17	16	15	14	13							
7													
8	19	20	21	22	23	24							
9													
10	30	29	28	27	26	25							
11													
12	31	32	33	34	35	36							
13													

NOTE: Not more than 4 corners, all in the same town and range, may be recorded on this certificate.

- A. Description of original monument and accessories and/or subsequent restoration:
- 1847: Original Survey by James H. Mullett - B.T.'s - Tamarack, 11", N20°W, 22 lks; Cedar, 6", S16°E, 12 lks. No original evidence for this corner was recovered.
 - 1884: Survey by Orson Burlingame, surveyor, shows this corner in relation to other corners in the S1/2 of Section 20. No corner description or B.T.'s are given.
 - 1976: Certified Survey No. 63 by George B. Wilson, RLS No. 17607, shows this corner as it relates to other corners in Section 21, T32N-R27W. The corner monument is not described.

- B. Description of corner evidence found and/or method applied in restoring or reestablishing corner:
- We found a 4 inch diameter concret monument with a 1/2 inch diameter iron pin at an ancient fence corner. Fences run North - South and East from this location. The monument fits recorded distances to other survey corners from Certified Survey No. 63, mentioned in part "A". This corner has been used by local surveyors for 18 years, and is accepted as the best available evidence of the position of the original corner.

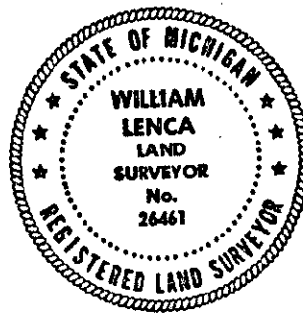

- C. Description of monument for corner and accessories established to perpetuate locating the position of the corner:

Accepted 4" square concrete monument - set 3-1/4" dia. Alum. Cap stamped for corner:

6" dia. Maple	N34°E	11.38 feet	Scr. NBT
6" dia. Elm	S62°E	36.93 feet	Scr. NBT
9" dia. Tamarack	S40°W	19.59 feet	Scr. NBT
9" dia. Maple	N64°W	19.33 feet	Scr. NBT
Survey Sign Post	N45°W	0.8 feet	

NOTE: All bearings are magnetic bearings. All distances are measured with steel tape. Distances to trees are to nail in side of tree.

Signed by William Lenca Date Dec. 12, 1994
Surveyor's Michigan License No. 26461