

SURVEY & REMONUMENTATION
APR 11 1995
COMMISSION

LAND CORNER RECORDATION CERTIFICATE
 Filing Requirement of Act 74, Mich. P.A. 1970

Approved by Menominee County
 Land Survey Remonumentation
 Four Group Under Act 345 Of
 P.A. Of 1990 On Dec 16, 1994
W. Lenca RLS
 ACTING Chairman

For corners in
MENOMINEE
 (County)

Located In: Corner Code #

- | | | | | |
|------------------------------------|---|-------------|------------|-------------|
| 1. Public Land Survey | T | <u>32NR</u> | <u>27W</u> | <u>E-09</u> |
| | T | _____ | _____ | _____ |
| | T | _____ | _____ | _____ |
| | T | _____ | _____ | _____ |
| 2. Property Controlling in Section | S | _____ | _____ | _____ |
| | S | _____ | _____ | _____ |
| 3. Miscellaneous Property in Sec. | S | _____ | _____ | _____ |
| | S | _____ | _____ | _____ |

RECEIVED FOR RECORD
 94 DEC 27 AM 10:49
 CARBARA MORRISON
 REGISTER OF DEEDS
 MENOMINEE MI 49858
 Register of Deeds Stamp & File Number

4. Lot No. _____, Recorded Plat _____
 5. Private Claims _____

William Lenca May 17 1994

I, _____, in a field survey on _____, 19____, do hereby certify that under requirements of P.A. 74, Michigan P.A. of 1970, the corner points mentioned in lines 1 and 2 above were in conformance with regulations and rules therefore as required in the current manual of survey instructions of the United States Department of the Interior, Bureau of Land Management or by a decree of a Court of Law and/or that the corner points mentioned in lines 3, 4 and 5 above were in conformance with the rules of the Michigan Board of Land Surveyors or by a Decree of a Court of Law; established, re-established, monumented, re-monumented, recovered, found as expressed below:

NOTE: Not more than 4 corners, all in the same town and range, may be recorded on this certificate.

A	B	C	D	E	F	G	H	I	J	K	L	M
2	6	5	4	3	2	1						
3												
4	7	8	9	10	11	12						
5												
6	18	17	16	15	14	13						
7												
8	19	20	21	22	23	24						
9												
10	30	29	28	27	26	25						
11												
12	31	32	33	34	35	36						
13												

A. Description of original monument and accessories and/or subsequent restoration:

- 1847: Original Survey by James H. Mullett - B.T.'s - Beech, 12", N41°E, 27 lks; Beech, 5", S43.5°W, 16 lks. All original evidence for this corner has been destroyed by county road improvements.
- 1886: Survey by Orson Burlingame, surveyor, shows this corner in relation to other corners in Section 29. The corner monument is not described and no new ties are given.
- 1973: L.C.R.C. No. 65 by George B. Wilson, RLS No. 17607, states that an iron pin was found 12" below road surface. Measurements check fence to the west at 1392.6' as surveyed March 1886 by Orson Burlingame. Wilson states that he set a 2" galvanized iron pipe 30" long/brass cap stamped for corner. Ties - NE Cor. House - SW - 147.37' & SE Cor. House - SW - 128.65'.

B. Description of corner evidence found and/or method applied in restoring or reestablishing corner:

We found a cast aluminum Berntsen W-1-B monument in location indicated by measurements shown in L.C.R.C. No. 65 (See part A). We believe that Wilson replaced his 2" x 30" iron pipe with the aluminum monument, since it fits the corner location, and is typical of corner monuments set in the area by George Wilson. This corner location has been used by local surveyors for more than 20 years, and is accepted as the best available evidence of the position of the original corner.

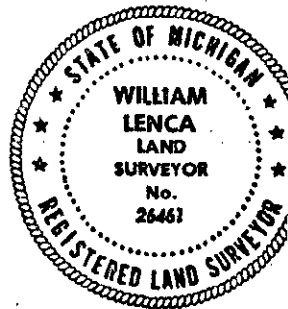

C. Description of monument for corner and accessories established to perpetuate locating the position of the corner:

Set 5/8" x 24" Iron Rod/3-1/4" dia. Alum. Cap stamped for corner in Monument Box in place of existing W-1-B:

Set 5/8" x 24" Iron Rod/2" dia. cap marked WITNESS MARKER	N30°E	74.53 feet
Set 5/8" x 24" Iron Rod/2" dia. cap marked WITNESS MARKER	S70°E	131.98 feet
Northeast Corner House Foundation	S14°W	128.65 feet
Set 5/8" x 24" Iron Rod/2" dia. cap marked WITNESS MARKER	N59°W	97.97 feet
Survey Sign Post	N30°E	74.7 feet

NOTE: All bearings are magnetic bearings. All distances are measured with steel tape. Distances to trees are to nail in side of tree.

Signed by William Lenca Date Dec. 12, 1994
 Surveyor's Michigan License No. 26461