

SURVEY & MONUMENTATION

LAND CORNER RECORDATION CERTIFICATE
Filing Requirement of Act 74, Mich. P.A. 1970

Approved by Menominee County
 Land Survey Re-Commission
 Four Group Under Act 345 Of

P.A. Of 1990 On DEC 12, 1994

For corners of
MENOMINEE
 (County)

APR 11 1995

COMMISSION

Located In:

Corner Code #

1. Public Land Survey	T	<u>32N</u> R	<u>27</u> W	<u>F-09</u>
	T	_____	_____	_____
	T	_____	_____	_____
	T	_____	_____	_____
2. Property Controlling in Section	S	_____	_____	_____
	S	_____	_____	_____
3. Miscellaneous Property in Sec.	S	_____	_____	_____
	S	_____	_____	_____

RECEIVED FOR RECORD
 DEC 27 AM 10:48
 BARBARA MORRISON
 REGISTER OF DEEDS
 MENOMINEE MI 498088
 Chairman
 # 195 BK: 4

Register of Deeds Stamp & File Number

4. Lot No. _____, Recorded Plat _____
 5. Private Claims _____

William Lenca

May 05, 1994

I, _____, in a field survey on _____, 19____, do hereby certify that under requirements of P.A. 74, Michigan P.A. of 1970, the corner points mentioned in lines 1 and 2 above were in conformance with regulations and rules therefore as required in the current manual of survey instructions of the United States Department of the Interior, Bureau of Land Management or by a decree of a Court of Law and/or that the corner points mentioned in lines 3, 4 and 5 above were in conformance with the rules of the Michigan Board of Land Surveyors or by a Decree of a Court of Law, established, re-established, monumented, re-monumented, recovered, found as expressed below:

	A	B	C	D	E	F	G	H	I	J	K	L	M
2	6	5	4	3	2	1							
3													
4	7	8	9	10	11	12							
5													
6	18	17	16	15	14	13							
7													
8	19	20	21	22	23	24							
9													
10	30	29	28	27	26	25							
11													
12	31	32	33	34	35	36							

NOTE: Not more than 4 corners, all in the same town and range, may be recorded on this certificate.

A. Description of original monument and accessories and/or subsequent restoration:

- 1847: Original Survey by James H. Mullett - B.T.'s - Black Ash, 6", N29°E, 6 lks; Black Ash, 5", S10°W, 25 lks. All original evidence for this corner has been destroyed by county road improvements.
- 1981: L.C.R.C. No. 320 by George B. Wilson, RLS No. 17607, states "Found old iron pin at road intersection used by old surveyors - Set HDR-1 Bernsten Monument - Ties: Deep 1 10' North & 10' East".
- 1983: Certified Survey No. 337 by George B. Wilson, RLS No. 17607, shows this corner as it relates to lot corners in the survey. The corner monument is not described.
- 1985: L.C.R.C. No. 692 by William Lenca, RLS No. 26461, states "This corner was destroyed by County Road improvements during Airport Construction, and was replaced using information in surveys tied to this corner. Set Railroad Spike - TIES: W. Ash, 8" - S03°W - 95.90'; Power Pole - S62°E - 136.89'; Power Pole - S80°W - 196.98'.

B. Description of corner evidence found and/or method applied in restoring or reestablishing corner:

We found a Railroad Spike and 3 witnesses as described in L.C.R.C. No. 692. This corner is in line with the centerline of a County Road running North and an old fence line running South. Based on measurements to lot corners in Certified Survey No. 337, the Railroad Spike is in the position of the old iron pin and HDR-1 Monument described in L.C.R.C. No. 320. This corner has been used by local surveyors for many years, and is accepted as the best available evidence of the position of the original corner.

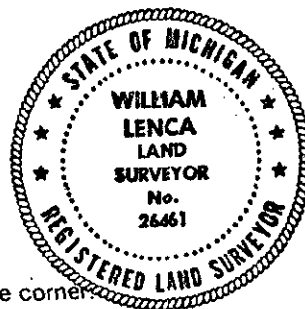

C. Description of monument for corner and accessories established to perpetuate locating the position of the corner:

Set 5/8" x 24" Iron Rod/3-1/4" dia. Alum. cap stamped for corner in Monument Box (in place of Existing Railroad Spike):

5/8" x 24" Iron Rod/2" alum cap marked WITNESS MARKER	N55°E	51.68 feet	
8" dia. Cedar	S18°E	109.90 feet	Scr. NBT
9" dia. White Ash	S03°W	95.90 feet	Scr. NBT
5/8" x 24" Iron Rod/Ident. cap	N42°W	47.27 feet	
Survey Sign Post	N42°W	48.3 feet	

NOTE: All bearings are magnetic bearings. All distances are measured with steel tape. Distances to trees are to nail in side of tree.

Signed by William Lenca
 Surveyor's Michigan License No. 26461

Date Dec. 15, 1994