

SURVEY & REMONUMENTATION

OCT 26 1993

COMMISSION

Approved by Menominee County
Land Survey Remonumentation
Peer Group Under Act 345 Of

P.A. Of 1990 On Oct 6, 19993

McLain RLS
Chairman (ACTING)

LAND CORNER RECORDATION CERTIFICATE

Filing Requirement of Act 74, Mich. P.A. 1970

For corners in

<u>MENOMINEE</u> (County)	Located In:	Corner Code #:
1. Public Land Survey	T <u>32N</u> R <u>27W</u>	<u>G-2</u>
	T _____ R _____	_____
	T _____ R _____	_____
	T _____ R _____	_____
2. Property Controlling in Section	S _____ T _____ R _____	_____
	S _____ T _____ R _____	_____
3. Miscellaneous Property in Sec.	S _____ T _____ R _____	_____
	S _____ T _____ R _____	_____
4. Lot No. _____, Recorded Plat _____		
5. Private Claims _____		

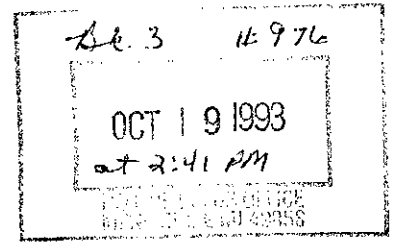

Register of Deeds Stamp & File Number

I, William Lenca, in a field survey on August, 1993, do hereby certify that under requirements of P.A. 74, Michigan P.A. of 1970, the corner points mentioned in lines 1 and 2 above were in conformance with regulations and rules therefore as required in the current manual of survey instructions of the United States Department of the Interior, Bureau of Land Management or by a decree of a Court of Law and/or that the corner points mentioned in lines 3, 4 and 5 above were in conformance with the rules of the Michigan Board of Land Surveyors or by a Decree of a Court of Law; established, re-established, monumented, re-monumented, recovered, found as expressed below:

NOTE: Not more than 4 corners, all in the same town and range, may be recorded on this certificate.

	A	B	C	D	E	F	G	H	I	J	K	L	M
2	6		5		4		3		2		1		
3													
4	7		8		9		10		11		12		
5													
6	18		17		16		15		14		13		
7													
8	19		20		21		22		23		24		
9													
10	30		29		28		27		26		25		
11													
12	31		32		33		34		35		36		
13													

A. Description of original monument and accessories and/or subsequent restoration:

ORIGINAL B.T.'s:

- Hemlock, 12", S06°W, 20 Lks.
- Hemlock, 8", N89°W, 08 lks.

Original Survey by James H. Mullett in 1848. All original evidence for this corner has been destroyed by farming and logging activities.

B. Description of corner evidence found and/or method applied in restoring or reestablishing corner:

Found 3/4" dia. Aluminum Rod/3 1/4" dia. Aluminum cap set by George B. Wilson, RLS 17607, in a 1981 survey. The corner position was located at the intersection of fence lines running North, South, East and West from this location. This corner was previously recorded in Book 1 of Corner Records on page 330, and is accepted as the best available evidence of the position of the original corner.

C. Description of monument for corner and accessories established to perpetuate locating the position of the corner:

Found 3/4" dia. Aluminum Rod/3 1/4" dia. Aluminum cap stamped for corner:

- | | | |
|-------------------|--------|------------|
| 8" dia. Cherry | N02°W, | 22.95 feet |
| 5" dia. White Ash | S88°E, | 23.83 feet |
| 5" dia. White Ash | S14°E, | 19.23 feet |
| 4" dia. Spruce | N67°W | 27.16 feet |
| Steel Sign Post | East | 2.0 feet |

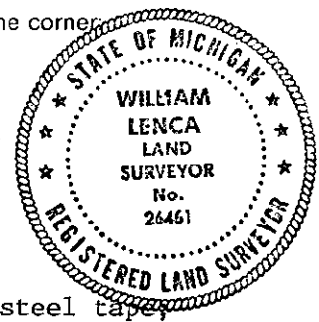

NOTE: All bearings are magnetic bearings; distances are measured with steel tapes; distances to trees are to nail in center of tree.

Signed by William Lenca Date Sept. 20, 1993

Surveyor's Michigan License No. 26461