

SURVEY & REMONUMENTATION

OCT 26 1993

COMMISSION

For corners in

MENOMINEE
(County)

Located In:

Corner Code #:

- | | | |
|---------------------------------------|---------------------------|------------|
| 1. Public Land Survey | T <u>32N</u> R <u>27W</u> | <u>H-1</u> |
| | T _____ R _____ | _____ |
| | T _____ R _____ | _____ |
| | T _____ R _____ | _____ |
| 2. Property Controlling in Section | S _____ T _____ R _____ | _____ |
| | S _____ T _____ R _____ | _____ |
| 3. Miscellaneous Property in Sec. | S _____ T _____ R _____ | _____ |
| | S _____ T _____ R _____ | _____ |
| 4. Lot No. _____, Recorded Plat _____ | | |
| 5. Private Claims _____ | | |

Approved by Menominee County
Land Survey Remonumentation
Peer Group Under Act 345 Of
P.A. Of 1990 On OCT 6, 199 23
Muldowney PLS
Chairman (ACTING)

LAND CORNER RECORDATION CERTIFICATE Filing Requirement of Act 74, Mich. P.A. 1970

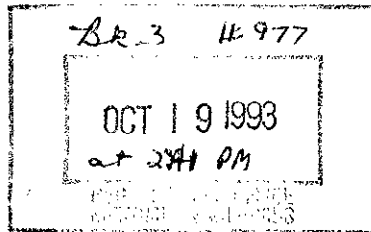

Register of Deeds Stamp & File Number

	A	B	C	D	E	F	G	H	I	J	K	L	M
2	6	5	4	3	2	1							
3													
4	7	8	9	10	11	12							
5													
6	18	17	16	15	14	13							
7													
8	19	20	21	22	23	24							
9													
10	30	29	28	27	26	25							
11													
12	31	32	33	34	35	36							
13													

I, William Lenca, in a field survey on August, 1993, do hereby certify that under requirements of P.A. 74, Michigan P.A. of 1970, the corner points mentioned in lines 1 and 2 above were in conformance with regulations and rules (hereafter as required in the current manual of survey instructions of the United States Department of the Interior, Bureau of Land Management or by a decree of a Court of Law and/or that the corner points mentioned in lines 3, 4 and 5 above were in conformance with the rules of the Michigan Board of Land Surveyors or by a Decree of a Court of Law, established, re-established, monumented, re-monumented, recovered, found as expressed below.

NOTE: Not more than 4 corners, all in the same town and range, may be recorded on this certificate.

A. Description of original monument and accessories and/or subsequent restoration:

ORIGINAL B.T.'s:

- Hemlock, 14", N40°E, 30 lks
- Hemlock, 8", N58°W, 40 lks

Original Survey by James H. Mullett in 1848. All original evidence for this corner has been destroyed by county road improvements.

B. Description of corner evidence found and/or method applied in restoring or reestablishing corner:

Found 4" square concrete monument in Monument Box set by George B. Wilson in a survey dated 11/16/79. The corner position falls in the centerline of County Road No. 320 (East-West) and in line with an old fence running South from this position. This corner was previously recorded in Book 1 of Corner Records on page 201, and is accepted as the best available evidence of the position of the original corner.

C. Description of monument for corner and accessories established to perpetuate locating the position of the corner:

4" square concrete monument in Monument Box:

- | | | |
|------------------|--------|------------|
| 6" dia. Tamarack | N26°E, | 53.11 feet |
| 4" dia. Tamarack | N03°W | 55.45 feet |
| 5" dia. Tamarack | S01°W | 35.50 feet |
| Steel Fence Post | N06°E | 50.00 feet |

NOTE: All bearings are magnetic bearings; distances are measured with steel tape; distances to trees are to nail in center of tree.

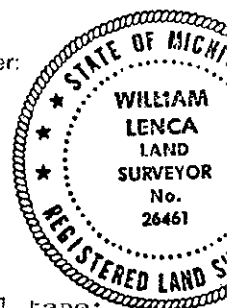

Signed by William Lenca Date Sept. 20, 1993
Surveyor's Michigan License No. 26461