

SURVEY & REMONUMENTATION

OCT 26 1993

Approved by Menominee County
Land Survey Remonumentation
Peer Group Under Act 345 Of

P.A. Of 1990 On OCT 6, 19993

McDermis RLS
Chairman (ACT 149)

LAND CORNER RECORDATION CERTIFICATE Filing Requirement of Act 74, Mich. P.A. 1970

For corners in

<u>MENOMINEE</u> <small>(County)</small>	Located In:	Corner Code #	
1. Public Land Survey	T <u>32N</u> R <u>27W</u>	<u>H-3</u>	
	T _____ R _____	_____	
	T _____ R _____	_____	
	T _____ R _____	_____	
2. Property Controlling in Section	S _____ T _____ R _____	_____	
	S _____ T _____ R _____	_____	
3. Miscellaneous Property in Sec.	S _____ T _____ R _____	_____	
	S _____ T _____ R _____	_____	
4. Lot No. _____, Recorded Plat _____			
5. Private Claims _____			

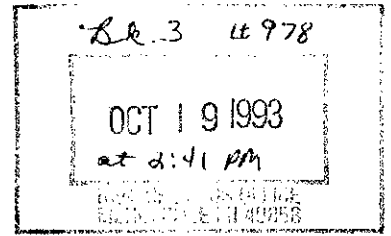

Register of Deeds Stamp & File Number

I, William Lenca, in a field survey on August, 1993, do hereby certify that under requirements of P.A. 74, Michigan P.A. of 1970, the corner points mentioned in lines 1 and 2 above were in conformance with regulations and rules therefore as required in the current manual of survey instructions of the United States Department of the Interior, Bureau of Land Management or by a decree of a Court of Law and/or that the corner points mentioned in lines 3, 4 and 5 above were in conformance with the rules of the Michigan Board of Land Surveyors or by a Decree of a Court of Law; established, re-established, monumented, re-monumented, recovered, found as expressed below:

NOTE: Not more than 4 corners, all in the same town and range, may be recorded on this certificate.

	A	B	C	D	E	F	G	H	I	J	K	L	M
2	6	5	4	3	2	1							
3								●					
4	7	8	9	10	11	12							
5													
6	18	17	16	15	14	13							
7													
8	19	20	21	22	23	24							
9													
10	30	29	28	27	26	25							
11													
12	31	32	33	34	35	36							
13													

A. Description of original monument and accessories and/or subsequent restoration:

ORIGINAL B.T.'s:

- Cedar, 8" dia. for Quarter Section Corner
- Cedar, 12", N40°E, 07 lks.

Original Survey by James H. Mullett in 1848.

B. Description of corner evidence found and/or method applied in restoring or reestablishing corner:

Found 2" dia. Iron Pipe/2½" dia. Brass cap stamped for corner location, set by George B. Wilson, RLS No. 17607, from 2 cedar stump holes fitting the position of the original B.T.'s as described in Part A. This corner is accepted as a careful and faithful perpetuation of the position of the original corner.

C. Description of monument for corner and accessories established to perpetuate locating the position of the corner:

2" dia. Iron Pipe/2½" dia. Brass cap stamped for corner location:

9" dia. Cedar	N40°E	18.31 feet
6" dia. Cedar	S74°E	25.39 feet
5" dia. White Ash	S24°W	10.78 feet
8" dia. Cedar	N14°W	27.71 feet
Steel Fence Post	North	0.9 feet

NOTE: All bearings are magnetic bearings; distances are measured with steel tape; distances to trees are to nail in center of tree.

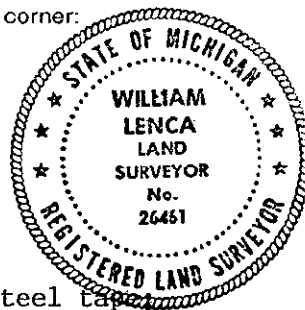

Signed by William Lenca Date Sept. 20, 1993

Surveyor's Michigan License No. 26461